



DESIGNED ARCHITECTURAL LIGHTING
PROJECTS
A PHOTOGRAPHIC HISTORY



Emirates Palace Hotel, Abu Dhabi

© Kempinski Hotels

Architect:
Wimberly Allison Tong and Goo

Lighting Consultant:
Lighting Design International (LDI), DHA Lighting

Within the hotel complex is the International Conference Centre of Abu Dhabi, the most luxurious meeting facility in the region, and seat of government. The extensive range of rooms and auditorium includes the magnificent 30m high conference hall.

To meet the needs and use of the space, and expectations of the design team, PAR downlighters and wallwasher were developed with variant spread lenses, cowls, and snoots. Specially designed pour boxes were also supplied.

DESIGNED ARCHITECTURAL LIGHTING

“Designed Architectural Lighting has supplied many different light fittings for a variety of projects over the years, both national and international. This brochure is a photographic record of just a few.”



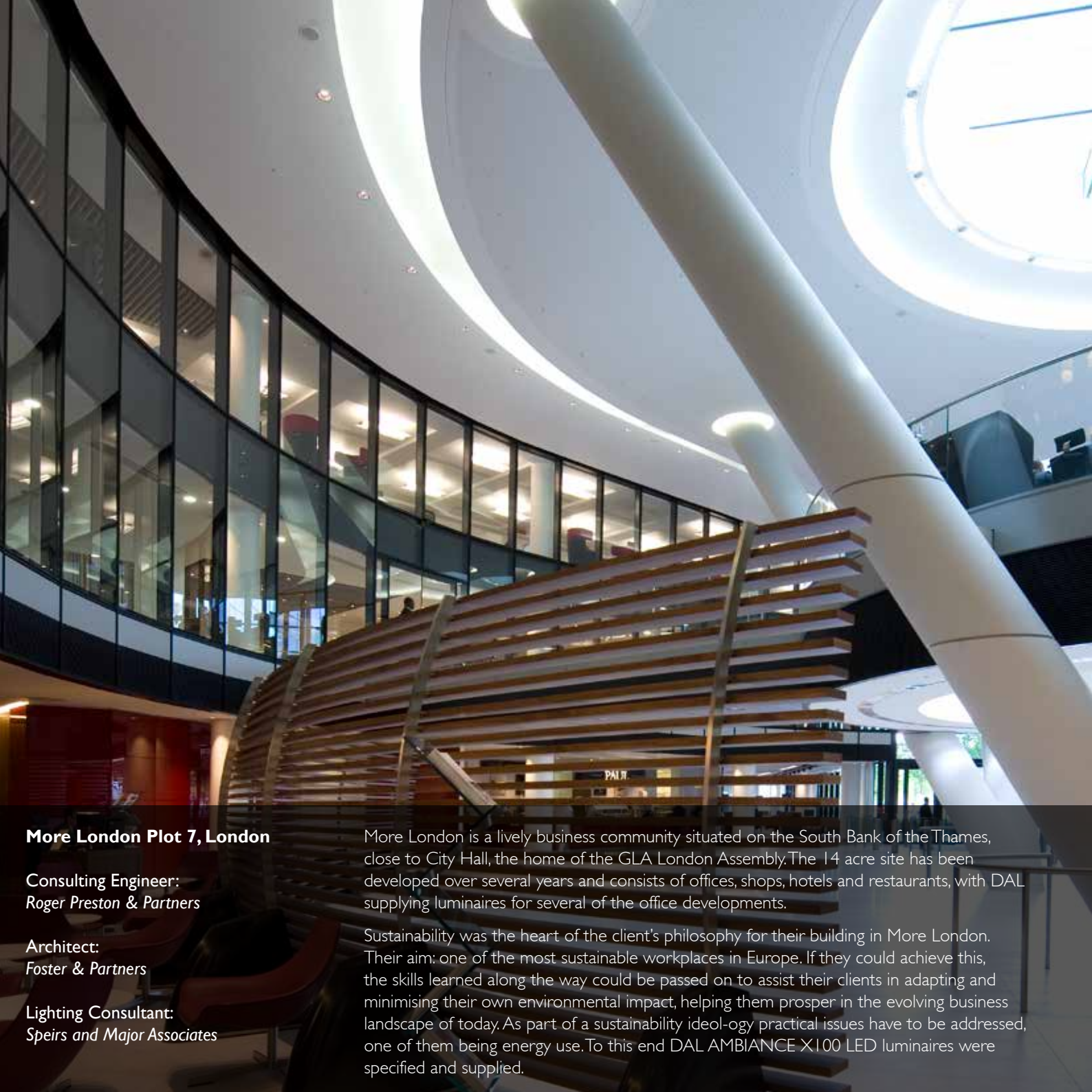

More London Plot 7, London

Consulting Engineer:
Roger Preston & Partners

Architect:
Foster & Partners

Lighting Consultant:
Speirs and Major Associates

More London is a lively business community situated on the South Bank of the Thames, close to City Hall, the home of the GLA London Assembly. The 14 acre site has been developed over several years and consists of offices, shops, hotels and restaurants, with DAL supplying luminaires for several of the office developments.

Sustainability was the heart of the client's philosophy for their building in More London. Their aim: one of the most sustainable workplaces in Europe. If they could achieve this, the skills learned along the way could be passed on to assist their clients in adapting and minimising their own environmental impact, helping them prosper in the evolving business landscape of today. As part of a sustainability ideology practical issues have to be addressed, one of them being energy use. To this end DAL AMBIANCE X100 LED luminaires were specified and supplied.

Major Commercial and Finance Projects

Amex - Sussex House, West Sussex
Heals, Alfred Mews
BMW Farnborough, Hampshire
120 High Holborn - Wainbridge Global
1 and 2 Ludgate
Network Rail, Euston Tower
Bush House, Aldwych, London
Millar Insurance, 70 Mark Lane, City of
London
Skype Offices
The Shard, London
London Bridge Tower
News International Fit Out - London
Bridge Place
La Garenne, Paris, France
20, Fenchurch Street - the Walkie Talkie -
City of London
62 Threadneedle St, City of London
Yinchuan Office Tower Ningxia, China
1, Threadneedle Street, City of London
3-10, Finsbury Square, City of London
Gazprom, 33 Kingsway, London
6, Bevis Marks, City of London
62, Buckingham Gate, London
Abbot House, Reading
Towers A, & B, Baku, Azerbaijan
BP, Baku, Azerbaijan
Botanic House, Cambridge
BP4, Churchill Place, Canary Wharf
Central St Giles, London
Chiswick Park, London
60, Holborn Viaduct, London
Savills, 33, Margaret Street, London

Savoy Hill House, London
Wellington House, The Strand, London
The Clove Building, Butlers Wharf,
London
Fishbourne Quay, Isle of Wight
Avaloq, Tanfield, Edinburgh
Air China Offices, London
Crystal Towers, Kuwait
BP Headquarters, Bedford Lakes,
Middlesex
Egyptian House, Jermyn Street, London
1, Finsbury Square, London
Brettenham House, London
Building 1000, Docklands, London
The Walbrook, City of London
One Lothbury, City of London
Monsoon Accessorize Headquarters,
London
20, Gresham Street, City of London
133, Houndsditch, City of London
10, Lancelot Place, London
The Royals Business Park, Docklands,
London
River Bank House, City of London
Ropemaker Place, City of London
Heron Tower, City of London
Transport for London, Greenwich
Broadgate Tower, City of London
ARUP Headquarters, Fitzrovia, London
Brookfield, 23, Hanover Square, London
200, Aldersgate Street, City of London
Tower Bridge House, London
Barclays Headquarters, Canary Wharf

Gibbs Building, Wellcome Trust, London
More London Development, Tooley
Street, London
Moor House, City of London
Adelaide House, London
50, Queen Anne's Gate, London
The Point, Paddington, London
New Street Square, London
Broadgate Development, City of London
Little Britain, City of London
Thames Court, City of London
Paternoster Square, City of London
Cazenove, City of London
J Sainsbury Headquarters, London
Deloitte Touche, City of London
Mid City Place, London
Glaxo Smithkline European Headquar-
ters, London
Orange Headquarters, London
1, London Wall, City of London
McGraw Hill, Canary Wharf
30, St Mary Axe, Swiss Re, City of
London
BG Group, Faraday Building, Reading
Exxon Mobile, Leatherhead
2, 3 & 4, Hardman Square, Spinningfields,
Manchester
Burj Khalifa, Dubai, UAE
Kuwait Trade Centre, Kuwait City
Exxon Mobile, Doha, Qatar
Federation Tower, Moscow
Goldman Sachs, London



The Shard

Architect:
Renzo Piano

Lighting Consultant:
ARUP Lighting

Construction Management:
MACE

Photographer:
© Dennis Gilbert/VIEW

Many of London's structures: Tower Bridge, St. Paul's Cathedral, The London Eye, vie for the title of top cityscape icon. Now it's The Shard that's drawing attention. Constructed over four years on a technically challenging site adjacent to London Bridge Station, amidst existing buildings, the 87 - story 1,004ft skyscraper forms the major part of The London Bridge Quarter. Opened to the public early in 2013, visitors can visit Level 69 and on a clear day view the panorama stretching for 40 miles.

As part of the project Designed Architectural Lighting supplied 3,000 luminaires of various types, including TEMPO XI61, CIVIC XI00 and AMBIANCE XI00 LED downlighters.



**Cardinal Place, Victoria,
London**

Architect:
EPR

Consulting Engineers:
Faber Maunsell

Photographer:
Peter Messett

TEMPO 161 and TEMPO 190 compact fluorescent downlighters and wallwashers were supplied to light the perimeter and other interior spaces at Cardinal Place. This prominent development, which includes a shopping centre, is situated opposite the striking facade of Westminster Cathedral. It is said the buildings rest on rubber shock absorbers to prevent vibrations from the passing District & Circle line underground trains that run close by.

Pedestrian
Subway



**Barclays PLC, Churchill Place,
Canary Wharf**

Consulting Engineer:
Hurley Palmer Flatt

Architect:
Pringle Brandon

Photographer:
Chris Gascoigne/View

The Barclays' 29-floor flagship building is sophisticated; not just for its state of the art office spaces but also the five landscaped atria, and 200-seat auditorium. DAL PRIMA downlighters were used extensively throughout, and AMBIANCE and TEMPO wallwashers light much of the specially commissioned artwork.



Monsoon Accessorize

Lighting Consultant:
NDYLIGHT

Architect:
*Allford Hall Monaghan
Morris Architects*

Located to the west of Notting Hill, Monsoon's new seven floor building has a central atrium that floods the interior with natural light. The building's structure includes an iconic concrete lattice framework. Concrete is also used to form part of a feature in the entrance lobby, in which Designed Architectural Lighting luminaire are integrated.

The Monsoon building is nicknamed the Yellow Building because of the distinctive yellow cladding used as part of the façade detail. To add to the building's presence at night and emphasise the strong architectural features of the shading fins, DAL Colonnade exterior drum up/downlighters are used as part of the exterior lighting design.



Unilever House, City of London

Lighting Consultant:
Speirs and Major Associates

Architect:
KPF

Unilever House was a two-fold project. DAL worked closely with the design team to upgrade and refurbish the existing art deco lights situated on the exterior of the building and within the entrance hall. (See Heritage Buildings and Architectural Features) For the new-build phase of the project DAL supplied a lighting package, which included PRIMA, METRO and AMBIANCE downlighter and wallwashers, and several custom designed luminaires.

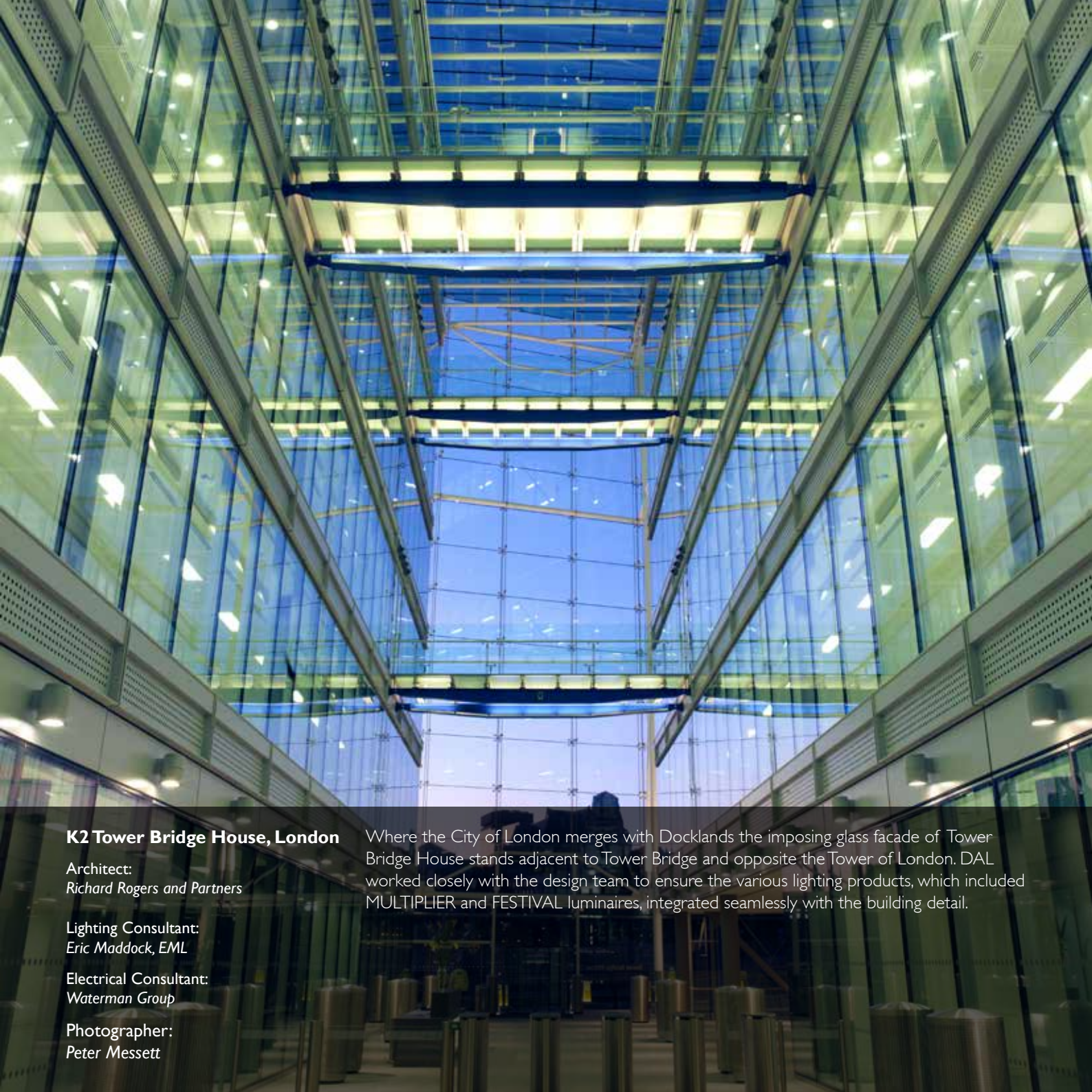

K2 Tower Bridge House, London

Architect:
Richard Rogers and Partners

Lighting Consultant:
Eric Maddock, EML

Electrical Consultant:
Waterman Group

Photographer:
Peter Messett

Where the City of London merges with Docklands the imposing glass facade of Tower Bridge House stands adjacent to Tower Bridge and opposite the Tower of London. DAL worked closely with the design team to ensure the various lighting products, which included MULTIPLIER and FESTIVAL luminaires, integrated seamlessly with the building detail.

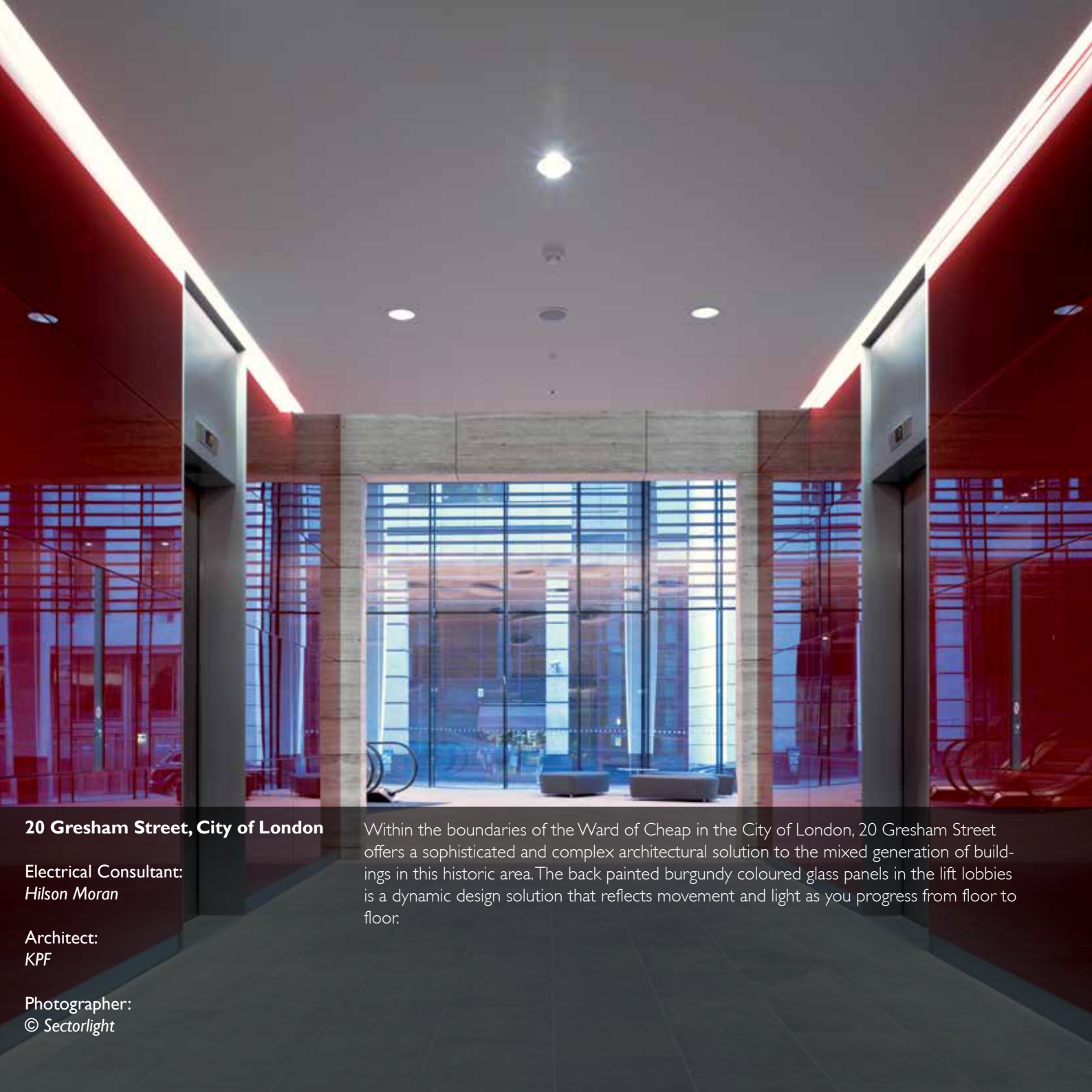

20 Gresham Street, City of London

Electrical Consultant:
Hilson Moran

Architect:
KPF

Photographer:
© *Sectorlight*

Within the boundaries of the Ward of Cheap in the City of London, 20 Gresham Street offers a sophisticated and complex architectural solution to the mixed generation of buildings in this historic area. The back painted burgundy coloured glass panels in the lift lobbies is a dynamic design solution that reflects movement and light as you progress from floor to floor.



**Paternoster Square, London
St Martin's Court**

Architects: *Allies and Morrison*

Electrical Consultant:
Waterman Group

Lighting Consultant: *Eric Maddock, EML*

Photographer: *Peter Messett*

After many years of architectural debate Paternoster Square is now a delightful environment and home to the London Stock Exchange. The site was once a bomb site, the buildings destroyed in the London Blitz. In the 1960s the site was filled with modernist office buildings and became the most hated site in London: considered grim against the beauty of Sir Christopher Wren's Cathedral.

DAL supplied standard and custom designed interior and exterior luminaires to two projects in the multi-building development fringing St Paul's Cathedral.



The Willis Building, City of London

Architect:
Foster + Partners

Photograph:
© Nigel Young/ Foster + Partners

Willis Group Holdings Limited, a leading global insurance broker, occupies the new Willis Building. It's unique architectural form, designed to mimic a crustacean, stands 28-storeys high, and is the fourth tallest skyscraper in the City. It is situated in Lime Street, in the heart of London's financial district, and stands opposite the renowned Lloyd's building.

Working with the consulting engineers Hurley Palmer Flatt on the fit-out programme, DAL supplied the TECNOLINE linear fluorescent system, which was integrated within the data centre. PRIMA 226 and TEMPO 190 downlighters and wallwashers were also used throughout the project.



Ludgate West, London

Architect:
SOM

Lighting Consultant:
Lighting Design International

Consulting Engineer: *JB&B*

Ludgate West, situated at the foot of Ludgate Hill on the edge of the City of London, offers a fine view of St Paul's Cathedral and its environs. Ludgate Hill is one of three ancient hills of London, the others being Tower Hill and Cornhill. There was once an actual Ludgate, leading into the City, but it was demolished in the 18th Century. The new development includes a pedestrian walkway and square that connects Fleet Plaza with Farringdon Street, which provides a welcome break in the cityscape of office buildings. DAL supplied TEMPO and METRO downlighters as part of a luminaire package for the shell and core areas.



More London Plot 7, London

Consulting Engineer:
Roger Preston & Partners

Architect:
Foster & Partners

Lighting Consultant:
Speirs and Major Associates

More London is a lively business community situated on the South Bank of the Thames, close to City Hall, the home of the GLA London Assembly. The 14 acre site has been developed over several years and consists of offices, shops, hotels and restaurants, with DAL supplying luminaires for several of the office developments.

Plot 7, was completed in late 2009 and is soon to be occupied by PricewaterhouseCoopers, the global firm of auditors and professional services providers for the business community. Included in the DAL lighting specification are METRO 190, TEMPO downlighters and wallwashers. Also in the package is a custom designed luminaire for the stairs, comprising an extruded profile with linear reeded opal diffuser.



**3i Investments PLC,
London Headquarters, London**

Lighting Consultant:
DPA Lighting Consultants

Interior Designer:
Swanke Hayden Connell Architects

Electrical Consultant:
Foreman Roberts

Photographer:
David Churchill

Utilising different lighting elements within each area of the building, DPA's design provides both appropriate illumination levels and a visually stimulating working environment. To meet their design requirements DAL supplied the majority of fixtures including VETRO multi lamp recessed luminaire, and TEMPO downlighters and wallwasher. The result was well received and awarded the British Council for Offices, London Regional Award 2006.



30 St Mary Axe, City of London

Lighting Consultant:
Speirs and Major Associates

Architect: *Foster + Partners*

Consulting Engineer: *Hilson Moran*

Photographer: *Nick Guttridge/VIEW*

Visitors to the 180 metre high building are drawn into the airy, cathedral-like lift lobby. The walls, clad in satin stainless tubes, are lit with downlighters. Mounted in a narrow slot offset from the wall by 250mm, the specular black cone fixtures are set at 500mm centres. Winner of the RIBA Stirling Prize 2004, the Swiss Re development at 30 St Mary Axe is also affectionately known as the Gherkin. DAL also supplied TEMPO and AMBIANCE downlighters together with several custom designed products as part of a bigger lighting package.



**20 Gresham Street,
City of London**

Electrical Consultant: *Hilson Moran*

Architect: *KPF*

Photographer: © *Sectorlight*

Named after Sir Thomas Gresham, the 16th Century merchant and financier, Gresham Street is situated in the heart of London's Square Mile. Located at the west end of the street, the site of this distinctive eight story building is diagonally opposite the City of London's Guildhall. Once inside, one cannot fail to be impressed by the double height entrance space and the magnificent sculpted travertine wall. Within the boundaries of the Ward of Cheap in the City of London, 20 Gresham Street offers a sophisticated and complex architectural solution to the mixed generation of buildings in this historic area. PRIMA, TEMPO wallwashers and downlighters were used extensively throughout the building.



Dubai International Finance Centre

Lighting Consultant:
*DPA Lighting Consultants
and Douglas Brennan*

Architects:
RMJM

Within the Gate Precinct of DIFC column mounted 70W CDM-T Colannade Up/Downlighter luminaires provide not only the ambient lighting but also feature pools of light. Mounted at six metre centres and three metre above the ground the lighting design emphasises the strong architectural lines of the building canopy.

DIFC is not just a financial centre but a complex of buildings housing a variety of social and cultural outlets, including galleries which promote Middle Eastern and International artists, a variety of shops and a hotel.



Central St. Giles

Architects:
Renzo Piano Building Workshop

The St Central Giles development is only a short distance from the east end of Oxford Street. The area was once the notorious Rookery, infamous for being one of the worst slums in London, inhabited by thousands of destitute people. It is said to be the Gin Lane, depicted by William Hogarth. Charles Dickens was also inspired by the people and locale, referring to it in his novel *Nicholas Nickleby*.

The distinctive colourful facades are controversial, not being in the vernacular architectural palate of London buildings. But, to many, the orange, yellow, green and lime glazed terracotta tiles are a joy. The development includes shops, restaurants, and offices for which DAL supplied a range of downlighters.



120, High Holborn

Consulting Engineer:
Hilson Moran

Architects:
John Robertson Architects

This John Seifert building on Holborn Circus was designed and built in the late 1970s. In 2015 the building was refurbished for Wainbridge Global, the real estate investment company. The company's aim is to rejuvenate out of date office buildings, particularly within the London Metropolitan Area.

As part of this high end specification DAL supplied recessed LIGHTLINE LED 60. At 65mm high with remote drivers the product was installed in plasterboard ceilings.



Skype Offices, Two Waterhouse Square, Holborn, London

Lighting Consultant: GIA Equation

Architect: TP Bennett

Photograph: ©Hufton+Crow

Skype London offices are situated in Two Waterhouse Square, Holborn. It is an innovative and exciting development in office design and covers three floors of this iconic building. The Skype workplace philosophy of bringing people together through communication and collaboration required lots of open plan spaces that supported planned and impromptu meetings, whether formal or informal. The aesthetic, smart but casual, led the design team to work with an array of natural fabrics in a palette of vibrant colours and classic patterns. With this in mind the lighting consultants and designers created with Designed Architectural Lighting a selection of pendant shade-lights that feature throughout the Skype offices. The project was shortlisted for the BCO London and South East Awards and the Lighting Design Award for Work Place Lighting, 2014.



Brent Civic Centre

Architect: Hopkins Architects

*Electrical and lighting specialists:
URS Scott Wilson*

Main Contractor: Skanska

M & E Contractor: Skanska

Facing the Bobby Moore statue at Wembley Stadium the new Civic Centre incorporates the Council's main administration offices together with Civic Chamber for council meetings, Wembley Public Library, marriage suites and grand banqueting hall. The aim is to provide a hub and heart for the community where residents can meet, shop and eat. With its internal amphitheatre a programme of high-quality arts and cultural experiences is planned. As the most sustainable local authority building to be completed in the UK so far, it features a combination of solar shading, natural ventilation, high-performance façade, and combined cooling, heating and power which utilises waste fish oil.

Government and Civic Buildings

Westminster Hall, London
Ansell Library, Foreign & Commonwealth
Office
Lunar House, UKBA, Croydon
The Ministry of Justice, London
Foreign and Commonwealth Office,
London
The British Library, London
Thames House, Millbank, London
Norman Shaw Building, Westminster
Richmond Terrace, Whitehall, London

National Physical Laboratory, Teddington
Hellenic (Greek) Parliament, Athens
British Embassy, Moscow, Russia
Parliament House, Singapore
Dubai Chamber of Commerce, UAE
British Embassy, Muscat, Sultanate of
Oman
British High Commission, Nairobi,
Kenya
New Parliamentary Building –
Phase I, London

Foreign and India Office, London
New British Library, London
Brent Civic Centre, Wembley
The Guildhall, City of London
Croydon Town Hall
Kidderminster Magistrate Court
Sheriff Courts, Scotland
Pontypridd Civic Chambers
Rochdale Town Hall
Woolwich Town Hall.



Brent Civic Centre

Architect: *Hopkins Architects*

Electrical and Lighting Specialists:
URS Scott Wilson

Main Contractor: *Skanska*

M & E Contractor: *Skanska*

Located on a prominent site next to two well-known civic icons, Wembley Stadium and Wembley Arena, the new Civic Centre houses all aspects of the Council's activities. Now the home of nearly 2000 civic, public and administrative staff, the building boasts many interesting architectural features including the soaring, naturally-lit foyer and atrium. Designed Architectural Lighting supplied well over 2,000 CIVIC G210 surface mounted downlighters for the project, which has been awarded the coveted BREEAM 'Outstanding' rating.



Brent Civic Centre

Architect:
Hopkins Architects

Electrical and Lighting Specialists:
URS Scott Wilson

Main Contractor:
Skanska

M & E Contractor:
Skanska

Brent Civic Centre is one of the many new buildings in the regeneration of the Wembley Park area, Wembley has a long history of unique and interesting building designs, including the relatively new Foster Architect's 2007 stadium with its iconic soaring arch. Also, there is the legacy of the original stadium built in 1923 for the Empire Exhibition; the twin towers etched in the psyche of almost every English football fan. Part of the Civic Centre's innovative design is a naturally-lit foyer and atrium, this houses a large amphitheatre suitable for public performances and events.

DAL CIVIC G210 surface mounted downlighters and TEMPO 161 recessed downlighters were supplied for the project.



The British Library

Architects: Colin St John Wilson

Consulting Engineer: SVM

Photographer: Paul Rattigan

The British Library is one of the world's leading research libraries, and its famous headquarters building is situated at St Pancras, between London's King's Cross and Euston stations. Formally opened by HM The Queen in 1998 it houses a significant number of the 150 million items held in the collection. This includes the impressive 'King's Library' displayed in a tall glass tower in the centre of the building. DAL designed, in close association with the architect and consultant, the readers desks. These were built to 'Rolls-Royce' standard, just one part of an exacting and detailed design brief.

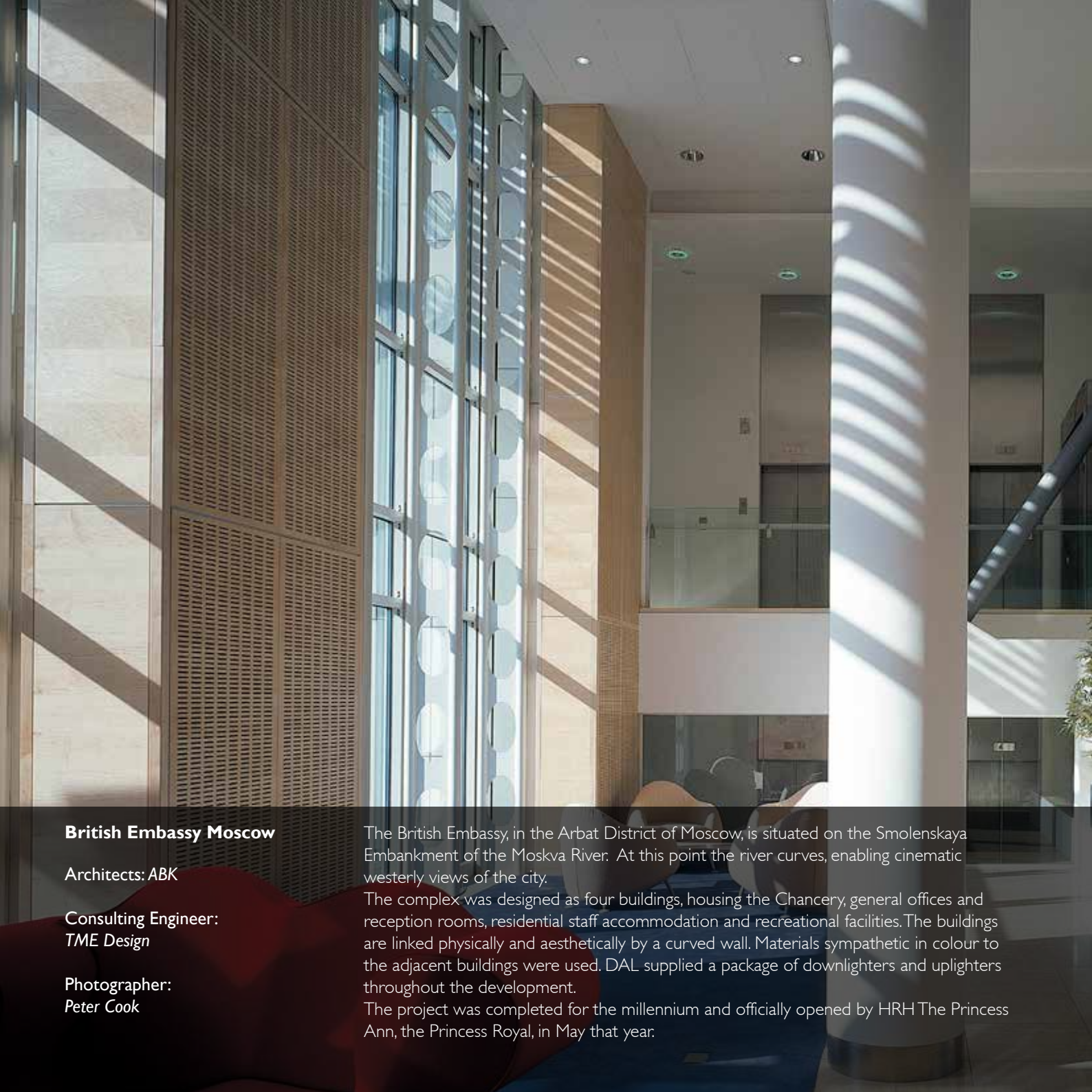

British Embassy Moscow

Architects: *ABK*

Consulting Engineer:
TME Design

Photographer:
Peter Cook

The British Embassy, in the Arbat District of Moscow, is situated on the Smolenskaya Embankment of the Moskva River. At this point the river curves, enabling cinematic westerly views of the city.

The complex was designed as four buildings, housing the Chancery, general offices and reception rooms, residential staff accommodation and recreational facilities. The buildings are linked physically and aesthetically by a curved wall. Materials sympathetic in colour to the adjacent buildings were used. DAL supplied a package of downlighters and uplighters throughout the development.

The project was completed for the millennium and officially opened by HRH The Princess Ann, the Princess Royal, in May that year.

DEO · OMNIPOTENTI
TEMPLVM · HOC · ARTIVM · ET · MV SARVM · ANNO · DOMINI · MCMXXXI
RECTORE · IOHANNI · REITH · PRIMI · DEDICANT · GVBERNATORES
PRECANTES · VT · MESSEM · BONAM · BONA · PROFERAT · SEMENTIS
VT · IMMVNDATA · OMNIA · ET · INIMICA · PACI · EXPELLANTVR
VT · QVAECVNQVE · PVLCHRA · SVNT · ET · SINCERA · QVAECVNQVE
BONAE · FAMAE · AD · HAEC · AVREM · INCLINANS · POPVLVS
VIRTVTIS · ET · SAPIENTIAE · SEMITAM · INSISTAT

**BBC Broadcasting House,
Portland Place, London**

Consulting engineer: *Faber Maunsell.*

Lighting Consultant: *Eric Maddock, EML.*

Photographer: *Andy Weller/VIEW*

The re-organisation and re-development of the BBC Portland Place site included the refurbishment of Broadcasting House 1930s' entrance hall. The architecturally listed interior was to remain the same so, as cleaning and renovation commenced, the lighting was removed from site and renovated and restored.

Heritage Buildings and Architectural Features

The Savoy Hotel, London
Senate House Library, University of
London
Cadogan Hall, Chelsea, London
The Royal Festival Hall, London
The Cloisters, University College London
Unilever House, Blackfriars, London
The British Museum Members' Rooms,
London
Hoover Building, London
Michelin House, London
St Paul's Crypt, London
The Guild Hall, London
Middle Temple, London
Prudential Assurance Headquarters,
Holborn Bars, London
The Guild Hall, Bath

Windsor Castle
New Register House, Edinburgh
White Tower, Tower of London
Bramshill House, Camberley, Surrey
Bath Spa
Cunard Building, Liverpool
New Register House, Edinburgh
Isle of Man Bank, Douglas
Exterior Architectural Features
The Savoy Hotel, Savoy Court Entrance,
London
Grandstand Entrance, AVIVA Stadium,
Lansdowne Road, Dublin
Cork Pedestrian Footbridge, Ireland
Monsoon Accessorize Headquarters,
London
British Airways London Eye, London

Millbank Millennium Pier, London
Waterloo Millennium Pier, London
Broadgate Estate Refurbishment, City of
London
Torquay Harbour Impoundment, Dorset
North and South Link, Broadgate, City of
London
Sun Street Passage, Broadgate Estate, City
of London
Court Hotel, Chelsea FC Stadium
West India Quay Footbridge, London
Docklands
Piccadilly Gardens, Manchester
Lowry Bridge, Salford Quays, Manchester

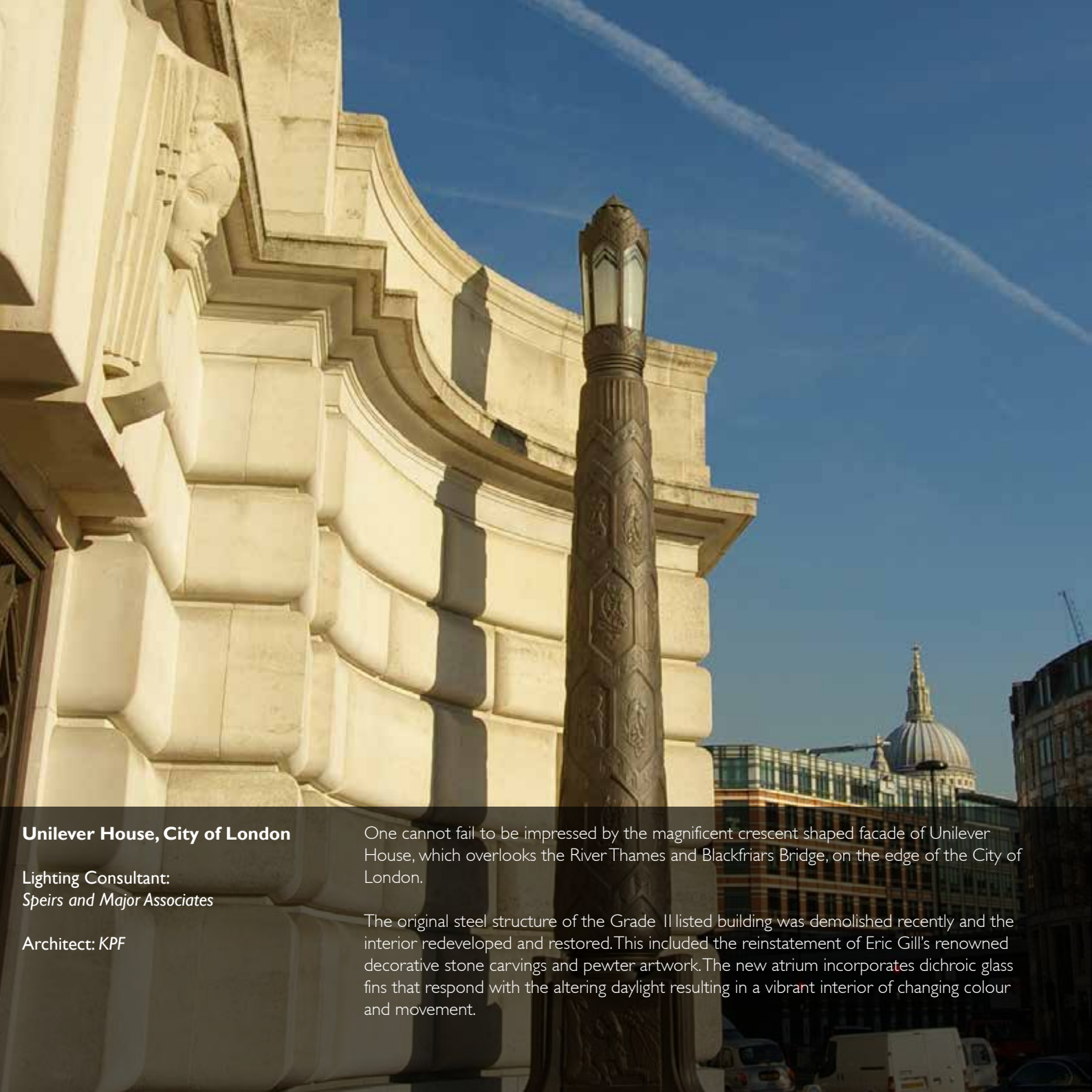

Unilever House, City of London

Lighting Consultant:
Speirs and Major Associates

Architect: *KPF*

One cannot fail to be impressed by the magnificent crescent shaped facade of Unilever House, which overlooks the River Thames and Blackfriars Bridge, on the edge of the City of London.

The original steel structure of the Grade II listed building was demolished recently and the interior redeveloped and restored. This included the reinstatement of Eric Gill's renowned decorative stone carvings and pewter artwork. The new atrium incorporates dichroic glass fins that respond with the altering daylight resulting in a vibrant interior of changing colour and movement.



The Hoover Building

Architect:

*Wallis, Gilbert and Partners/Lyons
Sleeman Hoare*

Engineer:

ACDP

Photographer:

Mathew Antrobus

Built in 1932 for The Hoover Company, the building is now an architectural icon of Britain's Art Deco heritage. Latterly, left to fall into disrepair it was finally saved by Tesco, the supermarket chain, who funded the restoration of the building in the 1990s. DAL not only refurbished the original Deco luminaires using modern light sources but also made updated replicas of those that were beyond repair.



**Broadgate Development,
Bishopsgate, City of London**

Architect:
SOM

Lighting Consultant:
Fisher Marantz Stone (FMS)

The development of offices, shops, bars and restaurants is one of London's most impressive modern precincts in the business district of London. Intriguingly, much of Broadgate's footprint is suspended over the tracks of Liverpool Street Station. On the eastern edge, at Bishopsgate, the imposing lighting columns flank the grand steps and walkways.

Designed Architectural Lighting designed and supplied the majority of the custom luminaires for the exterior of this multi-million pound development. The package of work included the clock hanging above 155, Bishopsgate.



**Broadgate Development,
5 Appold Street,
City of London**

Architect:
SOM

Lighting Consultant:
Fisher Marantz Stone (FMS)

Broadwalk House, completed in 1989, is the only building within Broadgate to have a reinforced concrete structure, the other buildings are of steel. The building's facade looks like terracotta tiles but is actually pre-cast concrete with some deeply sculpted architectural detailing.

DAL manufactured and supplied a great number of bespoke luminaires for both the interiors and exteriors of several buildings in this impressive modern precinct in the business district of London.



The Savoy Hotel, London

Architect:
Thomas Edward Colcutt / Buro Happold

Consultant:
Lighting Design International

The world famous Savoy Hotel first opened in August 1889. The Art Deco style Strand entrance with its polished silver metal façade was added in 1911. Many famous people have signed the guest book, including Claude Monet, Frank Sinatra, and Bob Dylan who filmed the video clip Subterranean Homesick Blues in an adjacent alley. The hotel was closed in 2007 for major refurbishment. Designed Architectural Lighting undertook the renovation of the iconic exterior cold cathode strip lighting detail.



**Prudential Building,
Holborn Bars, London**

Architect: *Alfred Waterhouse/EPR*

Consulting Engineer: *Ove Arup*

The Prudential first moved into the Alfred Waterhouse designed building in 1879. Situated on Holborn the Grade II listed building with its imposing red brick façade was refurbished in the 1990s and included the development of new light fittings acceptable to English Heritage. As part of the lighting package Alexandra luminaires were supplied in various sizes to suit different areas. Alexandra was originally designed in conjunction with Jonathan Speirs. The project won the City of London Heritage award in 1993. Alexandra was developed to answer the needs of historic buildings requiring sympathetically designed luminaires with high lumen packages, thus meeting contemporary illumination recommendations. Available in three sizes, the pendant luminaires are able to accept various lamp options, and the decorative rims and suspensions can be finished to the client's specification.

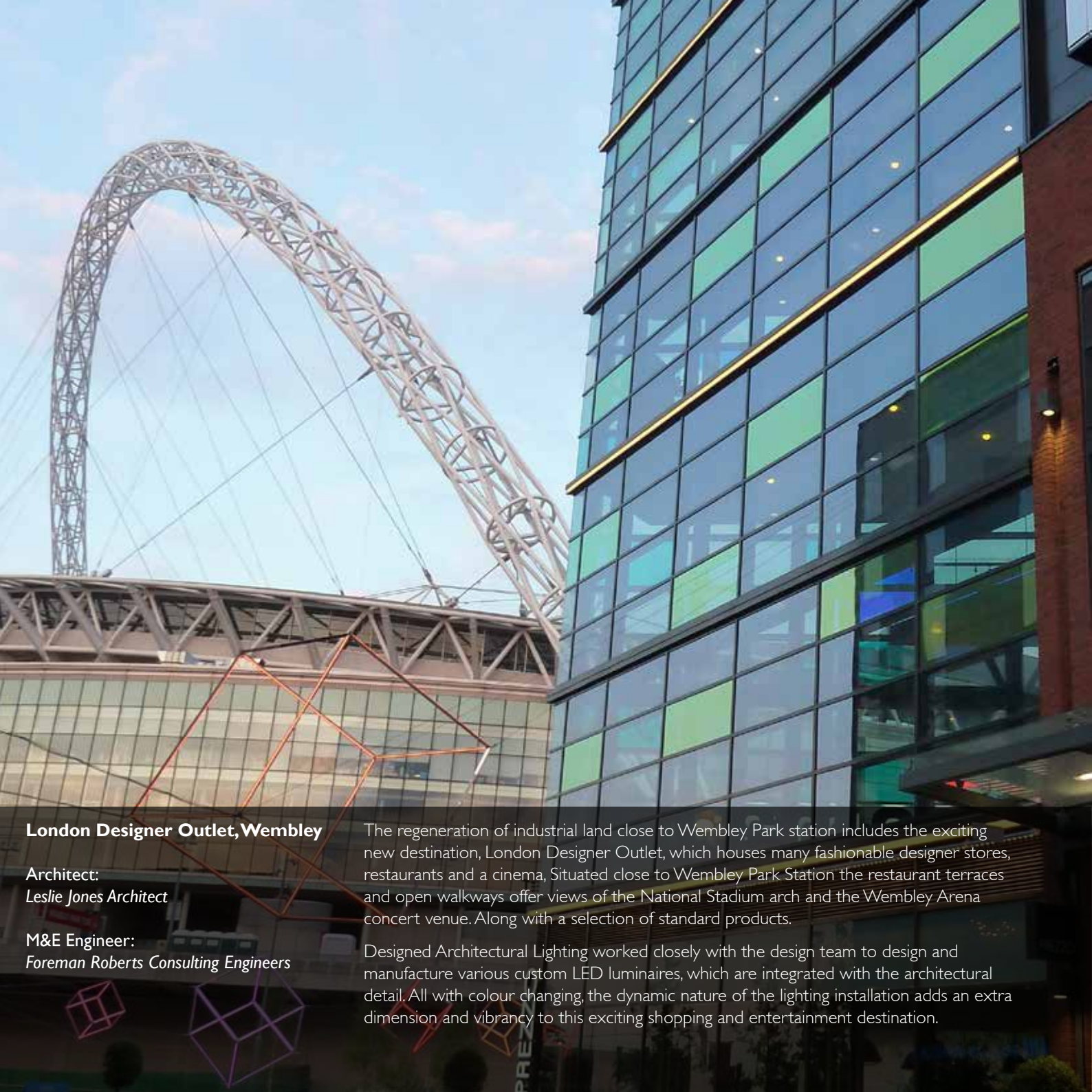

London Designer Outlet, Wembley

Architect:
Leslie Jones Architect

M&E Engineer:
Foreman Roberts Consulting Engineers

The regeneration of industrial land close to Wembley Park station includes the exciting new destination, London Designer Outlet, which houses many fashionable designer stores, restaurants and a cinema. Situated close to Wembley Park Station the restaurant terraces and open walkways offer views of the National Stadium arch and the Wembley Arena concert venue. Along with a selection of standard products.

Designed Architectural Lighting worked closely with the design team to design and manufacture various custom LED luminaires, which are integrated with the architectural detail. All with colour changing, the dynamic nature of the lighting installation adds an extra dimension and vibrancy to this exciting shopping and entertainment destination.

Hotels and Leisure

Costa Coffee
White City, Baku, Azerbaijan
Ritz Carlton, Vietnam
Ham Yard Hotel, Piccadilly, London
Genting Maxims Hotels
Bloomsbury Theatre, London
El Houra Golf, Tangiers
Hilton London, Wembley Stadium
Tottenham Football Club
Lotte Hotel, Seoul, South Korea
Hiboka Spa, Bratislava, Slovakia
The Hyatt Regency – Churchill Hotel, London
Shangri-La Garden Wing, Singapore
Westin Hotel, Singapore
InterContinental – Citystars, Cairo, Egypt
Sheraton Palace Hotel, Moscow, Russia
The Landmark Hotel, London
Yuda Palace Hotel, Zhengzhou
Crowne Plaza, London
Grosvenor House Hotel, London
Hotel Los Artes, Barcelona
Hyatt Regency, Thessaloniki, Greece
Athenee Palace, Djerba, Tunisia
Lotte Hotel, Moscow
Fairmont Tower, Heliopolis, Cairo
Sheraton Spa, Heliopolis, Cairo
Taj Gateway, Vadaroda, India
Western Hotel, Delhi, India
Marriott Hotel, Pune, India
Hotel Kohinoor, India
Oberoi Hotel, Kathmandu
Trou Aux Biches, Mauritius

One & Only, Maldives
Fairmont Hotel, Mecca, Saudi Arabia
Messilah Beach, Kuwait
Burj Al-Arab Hotel, Dubai
Jumeira Beach, Dubai
Mirage, Dubai
Emirates Palace, Abu Dhabi
Inter Continental Hotel, Abu Dhabi
Hyatt Regency Hotel, Muscat
Phoenicia Hotel Beirut, Lebanon
Island Shangri-La Hotel, Hong Kong
Mandarin Oriental Hotel, Hong Kong
Peninsula Hotel, Hong Kong
Excelsior Hotel, Hong Kong
Kowloon Shangri-La Hotel, Hong Kong
Regal Hotel, Chek Lap Kok, Hong Kong
Sheraton Hotel, Hong Kong
New World Hotel, Dalian, China
Shenyang Traders Hotel, China
Chang Chun Shangri-La Hotel, China
Mandarin Oriental Hotel, Macau
Venetian Hotel, Macau
Blue Water Events Venue, Kent
The Hard Rock Café, Florence, Italy
Samaxi Gym Villa, Azerbaijan
Corney and Barrow Cabin, Waterloo, London
Corney and Barrow, Mason's Avenue, City of London
Arsenal FC, Woolwich Lounge and Legends, Emirates Stadium, London
SAHiL Bar and Restaurant, Baku, Azerbaijan

The Royal Festival Hall, London
Aviva Stadium, Lansdowne Road, Dublin
Olympic Stadium, Stratford, London
The Football Association, Wembley Stadium, London
English National Opera, London
Coliseum
Novello Theatre, London
Fifty London, St James's, London
Electric Cinema, Notting Hill, London
Chelsea F.C. Training Academy, Cobham
Chelsea F.C. Redevelopment, Stamford Bridge, London
Real Tennis Court, Middlesex University, Hendon
Ebor Grandstand, York Racecourse
New Grandstand, Newbury Racecourse
Aberdeen Marine Club, Hong Kong
Café Casablanca, Tsimshatsui, Hong Kong
Foreign Correspondents Club, Hong Kong
Hong Kong Country Club, Hong Kong
American Club, Exchange Square, Hong Kong
China Max Restaurant, Hong Kong
Hong Kong Football Club
Royal Jockey Club, Hong Kong
Shenzhen Golf Club, China
Shenzhen Cultural Centre, China
Shanghai International Club, China

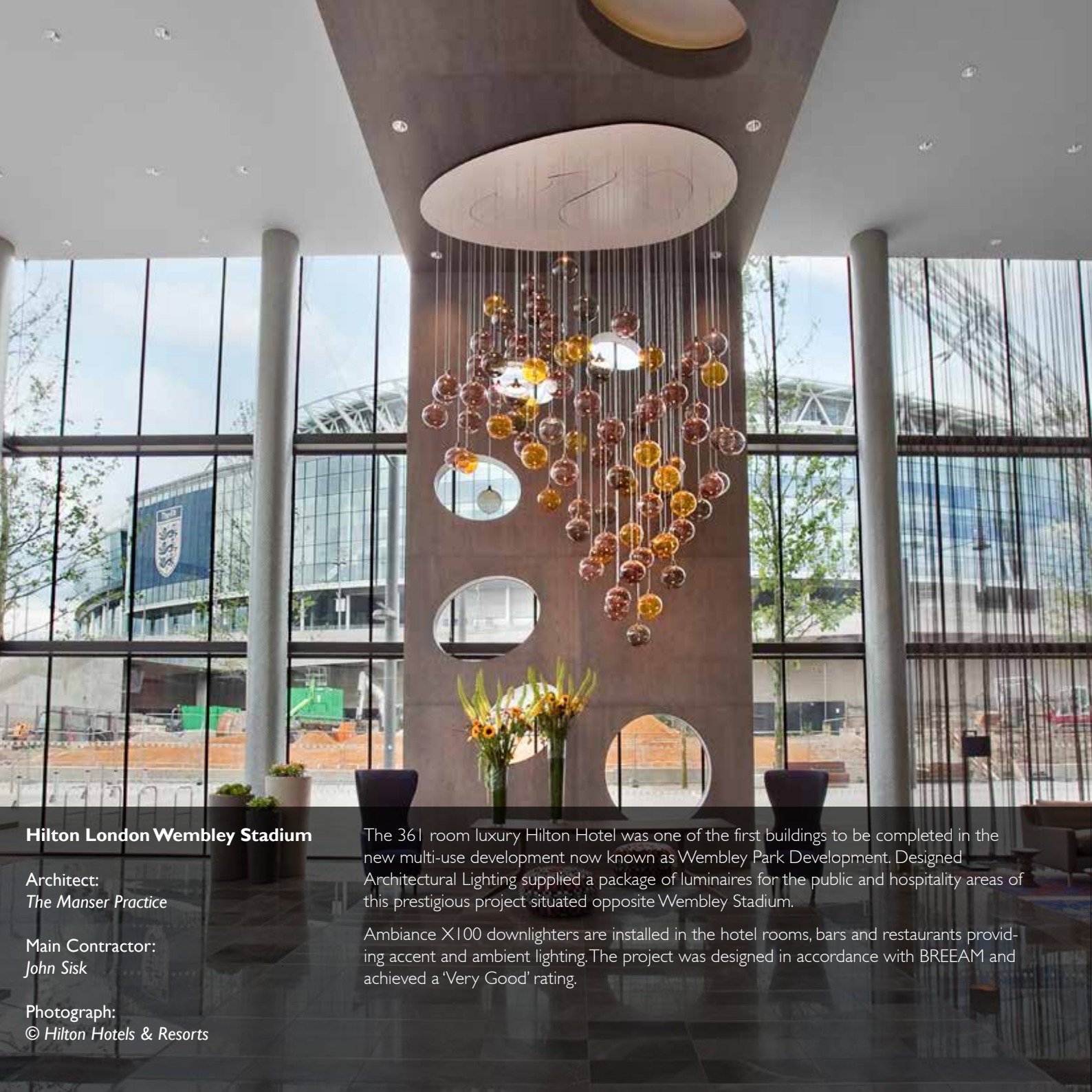

Hilton London Wembley Stadium

Architect:
The Manser Practice

Main Contractor:
John Sisk

Photograph:
© *Hilton Hotels & Resorts*

The 361 room luxury Hilton Hotel was one of the first buildings to be completed in the new multi-use development now known as Wembley Park Development. Designed Architectural Lighting supplied a package of luminaires for the public and hospitality areas of this prestigious project situated opposite Wembley Stadium.

Ambiance X100 downlighters are installed in the hotel rooms, bars and restaurants providing accent and ambient lighting. The project was designed in accordance with BREEAM and achieved a 'Very Good' rating.



Hilton London Wembley Stadium

Architect:
The Manser Practice

Main Contractor:
John Sisk

Photograph:
© *Hilton Hotels & Resorts*

With its proximity to Wembley Arena and the National Stadium the hotel has become a social hub within the regeneration of Wembley Park. Whether nursing a glass of whiskey or having a pre-match lunch in the stylish Icons Bar visitors can relax in the environments surrounded by the iconic Wembley Arch and the Arena.

The Arena, built originally as a swimming pool for the 1934 Empire Games, has with one of the largest ever built reinforced concrete roof spans, and has an English Heritage Grade II* listing.

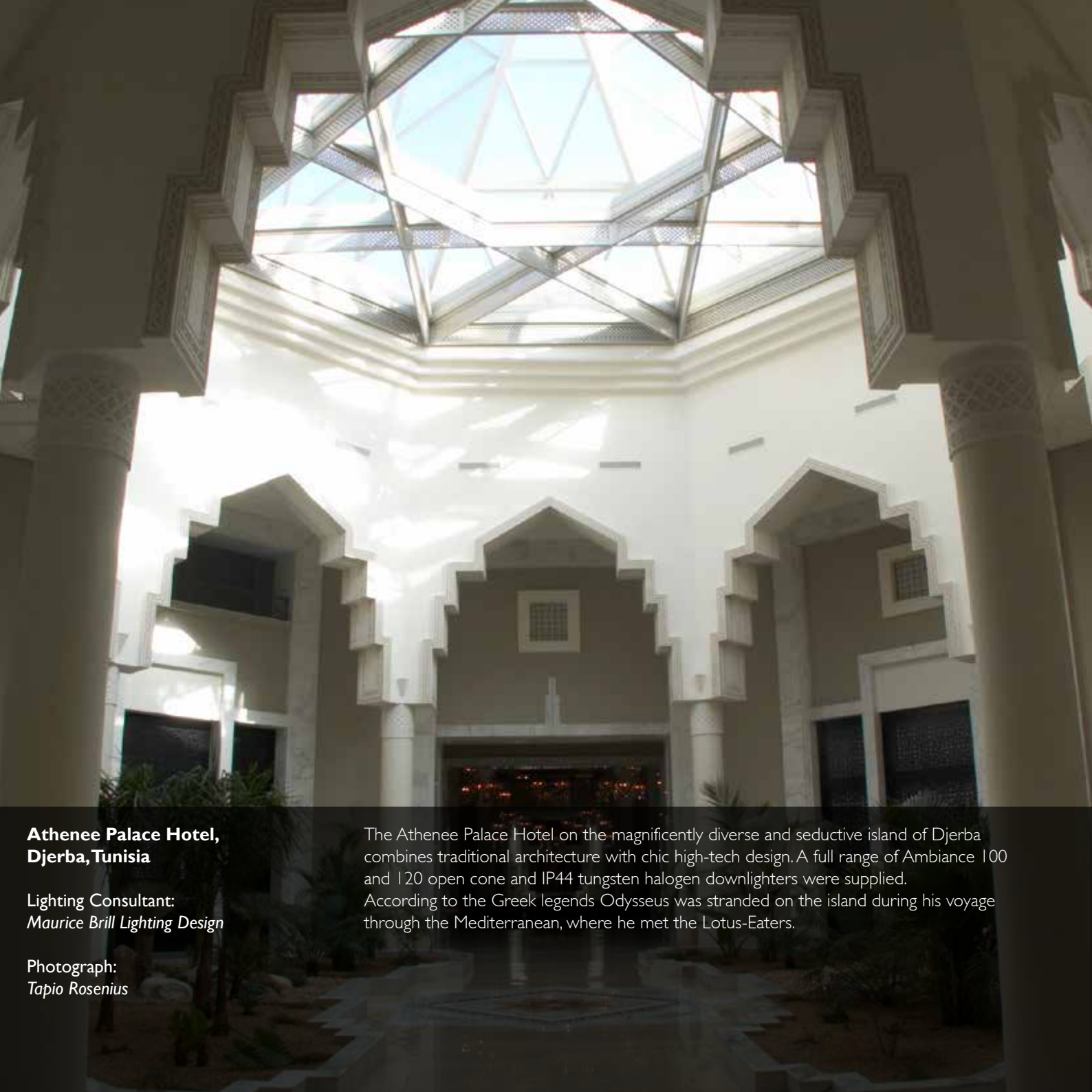

**Athenee Palace Hotel,
Djerba, Tunisia**

Lighting Consultant:
Maurice Brill Lighting Design

Photograph:
Tapio Rosenius

The Athenee Palace Hotel on the magnificently diverse and seductive island of Djerba combines traditional architecture with chic high-tech design. A full range of Ambiance 100 and 120 open cone and IP44 tungsten halogen downlighters were supplied. According to the Greek legends Odysseus was stranded on the island during his voyage through the Mediterranean, where he met the Lotus-Eaters.



Burj al Arab

Lighting Consultant:
Maurice Brill Lighting Design

Architects and Consultants:
WS Atkins

One of the world's most famous hotels the Burj al Arab soars 321 metres above the Gulf, dominating the Dubai coastline with its iconic billowing sail design. Much of the sumptuous, award-winning interior was lit using AMBIANCE 100 downlighters and directional downlighters. Over 14,000 were supplied for the project.



Fifty London

Lighting Design:
Lighting Design International

Architect:
Ettwein Bridges

Interior Design:
Jeffrey Beers International

50, St James' Street first opened in 1827 and became 'the most talked about gambling hall in the most talked about street in the most talked about city in the world', when The Duke of Wellington gambled under candlelight. Now the gaming tables of Fifty London are lit with ingeniously designed pendants.

The exacting brief required the lighting to be even, shadow-less, and glare-free for the players and the CCTV monitors. Cameras are incorporated in the pendants, which provide not only direct lighting from adjustable pinhole downlighters but also diffused, general lighting through traditional lampshade material.

The project was winner of the Lighting for Leisure category, Lighting Design Awards 2006.

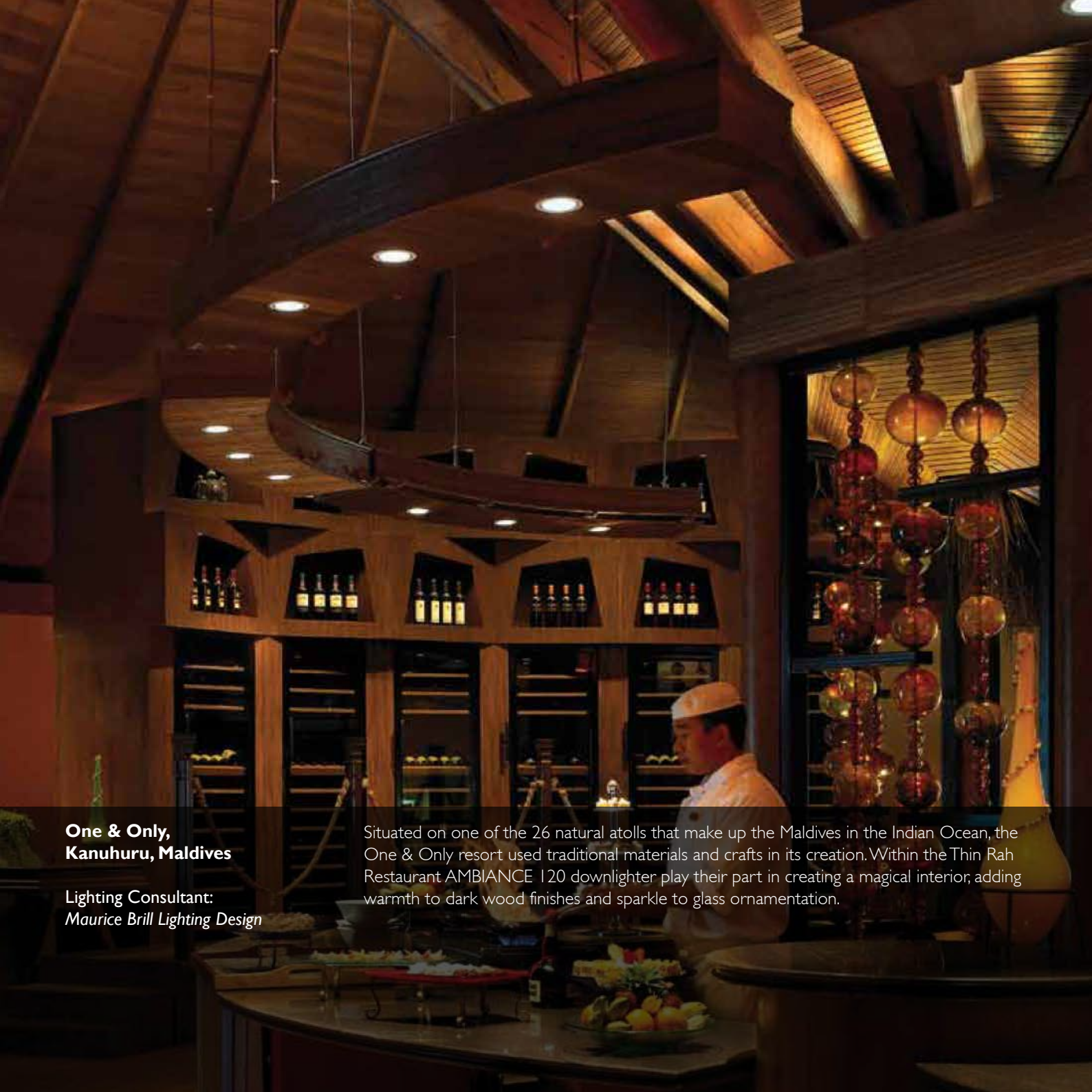

**One & Only,
Kanhuru, Maldives**

Lighting Consultant:
Maurice Brill Lighting Design

Situated on one of the 26 natural atolls that make up the Maldives in the Indian Ocean, the One & Only resort used traditional materials and crafts in its creation. Within the Thin Rah Restaurant AMBIANCE I20 downlighter play their part in creating a magical interior; adding warmth to dark wood finishes and sparkle to glass ornamentation.



Emirates Palace Hotel, Abu Dhabi

© Kempinski Hotels

Architect:
Wimberley Allison Tong and Goo

Lighting Consultant:
*Lighting Design International (LDI),
DHA Lighting*

The remarkable exterior architecture of the Conference Palace Hotel incorporates many traditional Arabic elements. The 114-domed building is constructed using materials that echo the different shades of sand found in the Arabian Desert.

Also, within the grounds is an international standard football pitch. Under the keen eye of His Highness Sheikh Mansour bin Zayed Al Nahyan, the owner of Manchester City Football Club, the Emirates Palace hotel is become the official training headquarter of the Club during the premier league close season.



Lotte Hotel, Seoul, South Korea

Lighting Consultant:
Project Lighting Design Singapore

Photograph:
© Lotte Hotel

Lotte Hotel is located in the Sogong neighborhood of Jung-gu, in the heart of Seoul. In Jung district tourists can experience a mixture of old and new cultures, where there are department stores and shopping malls jostling with cherished historic sites such as Deoksugung and Sungnyemun. Deoksugung is an historical walled Palace compound and the first National Treasure of South Korea. Sungnyemun is one of the eight gates in the fortress wall of Seoul.

Lotte has its own world of restaurants and bars, banqueting halls and conference suites, but amongst this exotic and busy environment is the luxurious haven of 'The Spa', winner of the 2013 Chrystal Award.



Tate Britain, London

Lighting Designer:
John Johnson, Lightwaves

The Tate Modern is situated on Millbank, on the site of the former Millbank Prison. The original gallery spaces opened 1897 was commonly known as the Tate, after Sir Henry Tate, the founder. It was renamed Tate Britain in 2000 becoming the home of historical and contemporary British art. The BALTIC spotlight is used extensively throughout Tate Britain and Tate Modern.

Museum and Galleries

Galerie Max Hetzler, Paris
Chinese Masters at the Victoria & Albert
Museum
Ikon Gallery, Birmingham
Leamington Spa Art Gallery
Plymouth Museum & Art Gallery
Imperial War Museum, London
Nottingham Castle Museum
Whitworth Art Gallery, Manchester
The Tanks, Tate Modern, London
Tate Britain, London
The Beaney, House of Art and Knowl-
edge, Canterbury
The Flaxman Gallery, Oculus,
University College London
York's CHOCOLATE Story, The Sweet
Museum, York
Government Art Collection,
Whitechapel Gallery, London
Olympia Exhibition Centre, London

National Portrait Gallery, London
The Royal Festival Hall Exhibition
Space, London
Natural History Museum, London
Whitechapel Gallery, London
White Cube Gallery, London
Arts Council England, London
The Courtauld Gallery, London
Foundling Museum, London
The Silver Galleries, Victoria & Albert
Museum, London
Mexican Gallery, British Museum,
London
National Portrait Gallery, London
Imperial War Museum, London
National Gallery, Sainsbury Wing,
London
Auditorium, Tate Modern, London
Hayward Gallery, London
The Ashmolean Museum of Art &

Archaeology, Oxford
Leeds City Art Gallery
Yeovil Art Gallery
The River & Rowing Museum, Henley
Compton Verney, Warwickshire
The Sainsbury Centre, Norwich
Tate of the North, Liverpool
Baltic Art Gallery, Gateshead
Scotch Whisky Heritage Centre,
Edinburgh
Museum of Scotland, Edinburgh
The Acropolis Museum, Athens
National Archaeological Museum of
Athens
MAS (Museum aan de Stroom),
Antwerp, Belgium
Moderna Museet, Stockholm
Museo Nacional de Bellas Artes, Santiago,
Chile
Imperial War Museum



**Gilbert and George:
Major Exhibition, Tate Modern,
London**

Lighting Designer:
John Johnson, Lightwaves

BALTIC spotlights have been used extensively in the TATE Galleries, and others, to light the special exhibitions as well as permanent displays.

The 'Art for All', anti-elitist artists, Gilbert & George, were awarded the Turner Prize in 1986.



**The Silver Gallery,
Victoria and Albert Museum,
London**

Designer: Ronayne Design. Lighting

Consultant: John Johnson, Lightwaves

Architect: Thomas Ford

Founded in the 1850s, the Victoria and Albert Museum houses the greatest and most diverse collection of decorative art and design in the world. Within this magnificent building are the Silver Galleries. But it is not just the breathtaking silver collection that is on display in the restored rooms. The rediscovery of the Minton tile columns and the silver leaf ceiling design called for the re-creation of the original gasolier sun burners to complete the project. The history of the museum and gas lighting was researched closely. The final design of the replica luminaire uses electric lamps instead of gas, and is manufactured in GRP instead of cast iron but is a sympathetic and successful interpretation of the original.



**The Beaney
House of Art and Knowledge,
Canterbury**

Architect:
John Miller & Partners with Sidell Gibson

The Beaney is a superb resource situated in the City of Canterbury's historic heart. Named after Dr James George Beaney, its original benefactor, the marvelous Tudor Revival building (Grade II listed) first opened in 1899 and now contains an art gallery, museum, library and educational facility.



**The Beaney
Special Exhibitions Room,
The Beaney House of Art and
Knowledge, Canterbury**

Architect:
*John Miller & Partners
with Sidell Gibson*

Curator: *Krystyna Matyjaszkiewicz*

Home, was a specially curated exhibition of work from the Arts Council Collection. An eclectic mix of Twentieth and Twenty First Century art - a selection of oils, drawings, photographs and film - it included works by Patrick Heron, Winifred Nicholson, Ceri Richards, William Roberts and Carel Wright. The Beaney being known as The House, the exhibition Home encompassed where we live, places of childhoods left behind, parental associations, also, places of memory and fantasy. Home is interpreted as somewhere to retreat to or escape from.



London Designer Outlet, Wembley

Architect:
Leslie Jones Architect

M&E Engineer:
Foreman Roberts Consulting Engineers

The new 'lifestyle destination' incorporates 85 shops, 15 restaurants and a 9-screen Cineworld. Sitting adjacent to Wembley Stadium and the Arena it adds a well needed social outlet to this now vibrant area.

Designed Architectural Lighting worked closely with the design team to design and manufacture various custom LED luminaires, which are integrated with the architectural detail. All with colour changing, the dynamic nature of the lighting installation adds an extra dimension and vibrancy to this exciting shopping and entertainment destination.

Retail and Shopping Centres

Ealing Broadway, Shopping Centre
London Designer Outlet, Wembley
County Mall, Crawley
Trinity Leeds
Palazzo Versace, Dubai
One New Change, City of London
Westfield Shopping Centre, White City,
London
St David's Centre, Cardiff
1, Knightsbridge Green, London
Bluewater Park, Kent
Lakeside, Essex
Arndale Centre, Stretford
The Shires, Leicester
Arndale Centre, Manchester
Silverburn Shopping Centre, Glasgow
Princes Square, Glasgow
Dundrum, Dublin, Ireland

Mahon Point, Cork, Ireland
Oxford Store, Antwerp, Belgium
Wijnegem Centre, Antwerp, Belgium
Meir Square, Antwerp, Belgium
Verso, Antwerp, Belgium
Centro Oberhausen, Germany
Mall of the Emirates, Dubai
Mirdiff City Centre, Dubai
The Avenues, Kuwait
Regent Place, Sydney, Australia
Stores and Retail Groups
Harrods, London
Waterstones – selected branches
M&S Diesel – selected branches
Marks & Spencer – selected branches
John Lewis, Stratford Westfield, London
Hobbs – selected branches
McArthur Glen – selected branches

Monsoon – selected branches
Gap – selected branches
Louis Vuitton, London
H&M Collection, London
Selfridges, London
Gucci, London
Jigsaw, London
Mulberry Showroom, London
John Lewis, Southampton
John Lewis, Glasgow
Prince Gem & Jewellery Pvt. Ltd,
Chennai, India
Centro Oberhausen, Germany
Mall of the Emirates, Dubai
Mirdiff City Centre, Dubai
The Avenues, Kuwait
Regent Place, Sydney, Australia



**Westfield, White City,
London**

Architect:
Benoy Architects

Photographer:
J M Delfino

With a central atrium purportedly the size of a football pitch, Westfield is one of Europe's largest in-town shopping centres. It is situated in West London beside Shepherd's Bush Green and close to the BBC Television Centre on Wood Lane. Bounded by the West Cross Road Route, underground and mainline railway lines, the reclaimed 43 acre brown-field site was once the location of the 1908 Franco-British Exhibition. Also held that year were the Olympic Games which took place in the White City Stadium, situated to the north of the site, where the BBC's new Broadcast Centre is now.

Westfield is a remarkable development with distinctive interior finishes of marble and granite, and it houses over 260 shops and stores which include many well known high street retailers and designer labels such as Ted Baker and Armani.



**Marks & Spencer,
Newcastle-upon-Tyne**

Lighting Consultant:
LAPD

Photograph:
Redshift

The lighting concept within this Marks & Spencer store includes recessed linear fluorescent luminaires to provide an even ambient level of illumination. Integrated in the ceiling 35W CDM metal halide and AR111 gimbal style adjustable downlighters, supply the highlights and accent lighting. This solution provides an uncluttered ceiling design and reinforces the clean lines of the shop layout.

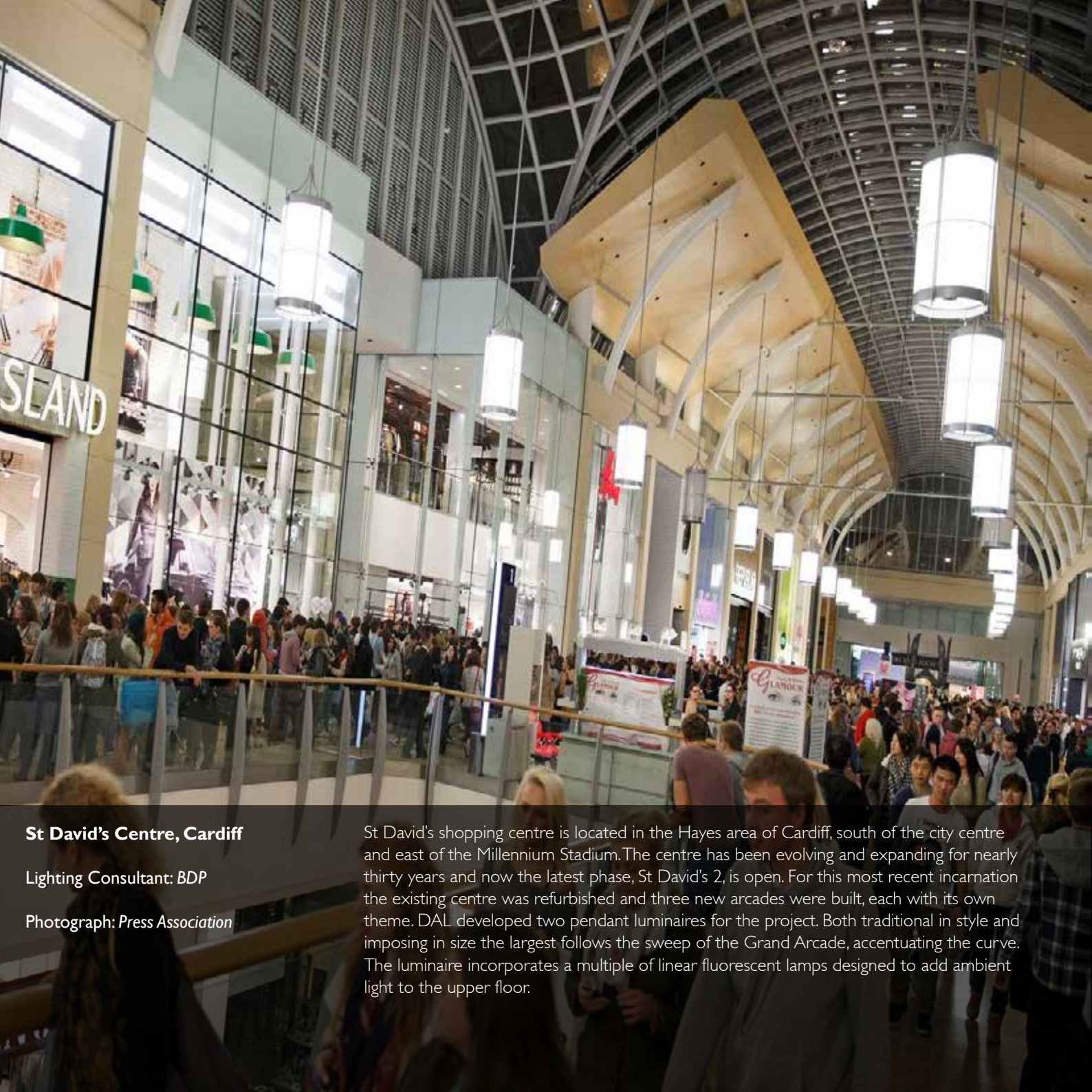

St David's Centre, Cardiff

Lighting Consultant: *BDP*

Photograph: *Press Association*

St David's shopping centre is located in the Hayes area of Cardiff, south of the city centre and east of the Millennium Stadium. The centre has been evolving and expanding for nearly thirty years and now the latest phase, St David's 2, is open. For this most recent incarnation the existing centre was refurbished and three new arcades were built, each with its own theme. DAL developed two pendant luminaires for the project. Both traditional in style and imposing in size the largest follows the sweep of the Grand Arcade, accentuating the curve. The luminaire incorporates a multiple of linear fluorescent lamps designed to add ambient light to the upper floor.



Highcross, Leicester

Lighting Consultant:
*WSP Lighting/Lighting Design
International*

Consulting Engineer: *WSP*

Architect: *Foreign Office
Architects/Chapman Taylor*

Photograph: *Hammerson plc.*

For centuries Highcross has been the economic hub of Leicester, and during the recent expansion of the town centre archaeologists unearthed finds that confirm Roman, Viking and Medieval settlements had all used it as a market place. Now the area has evolved again with the expansion of an existing mall and a new John Lewis store with a striking filigree patterned façade of cool white. Linking the shopping centre to the car park is double-height glass footbridge crossing over the street below, for which DAL supplied custom designed T2 recessed handrail lights. Another special product was a continuous T5 fluorescent trunking system with both symmetric and asymmetric distributions.



**Bluewater Park,
Greenhithe, Kent**

Lighting Consultant:
Speirs and Major

Opened in 1999 Bluewater was Europe's largest and most innovative retail and leisure destination. It is located amongst towering 50 metre high cliffs and surrounded by a tranquil landscape of lakes, parkland and trees. The custom designed pendant luminaires add ambient light to the shopping streets, as well as accent lighting the striking architecture.



**One New Change,
City of London.**

Lighting Consultant:
Speirs + Major

Architect:
*Jean Nouvel, in association with
Sidell Gibson*

Positioned opposite St Paul's Cathedral, One New Change lies entirely within Bread Street ward and is bounded by Cheapside to the north, Bread Street to the east, Watling Street to the south, and New Change to the west. Within the centre, the north-south arcade is called Cheapside Passage and the east-west arcade is New Change Passage. The shopping centre is located in an area of London's historic nucleus that was widely known for its retail 'Cheapside' being Old English for 'market-place'. DAL supplied a mix of standard and custom designed downlighters, illuminating the 'streets'. DAL also supplied BALTIC spotlights for Chef Jamie Oliver's butcher shop, Barbocoa, located on the Watling Street side of the development.

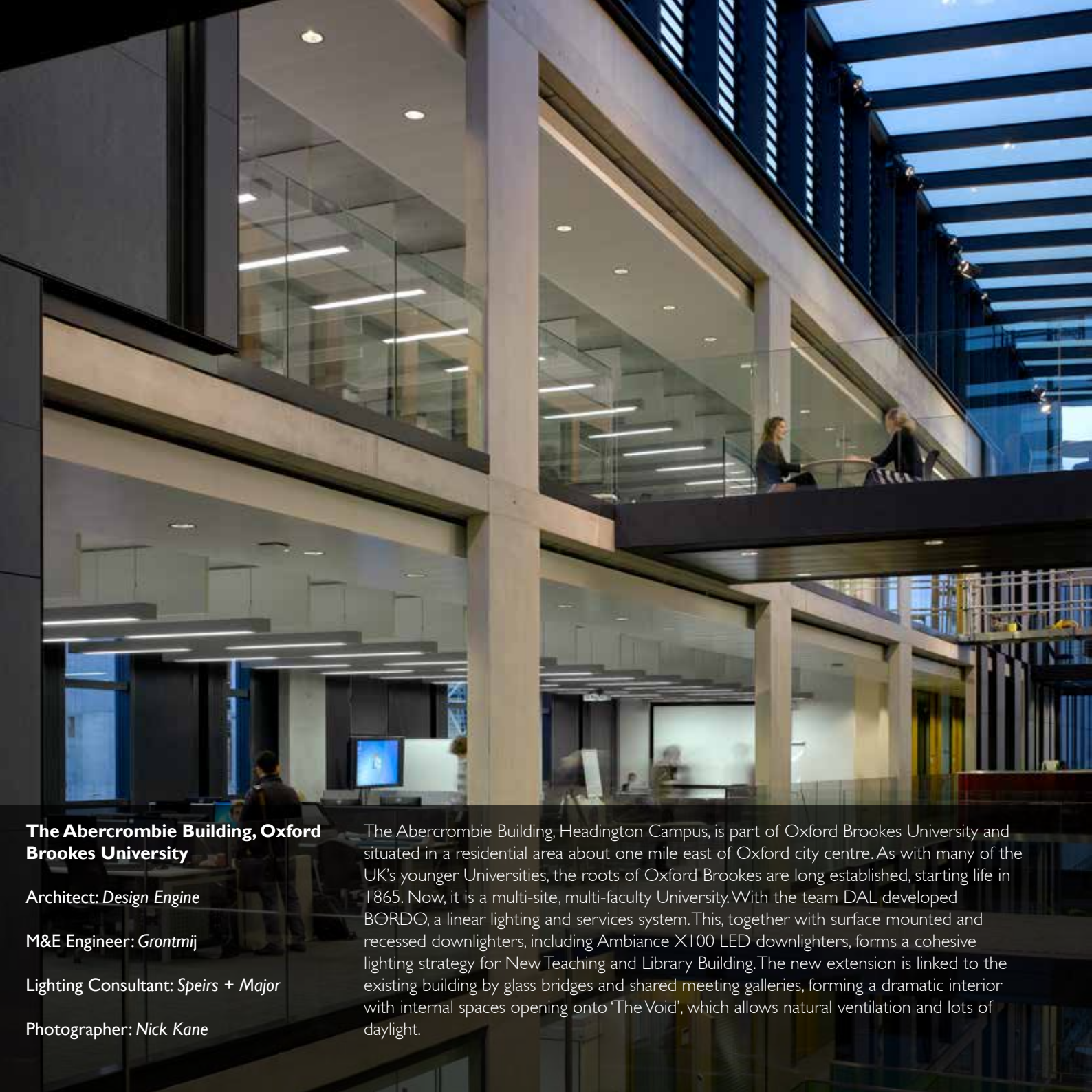

**The Abercrombie Building, Oxford
Brookes University**

Architect: Design Engine

M&E Engineer: Grontmij

Lighting Consultant: Speirs + Major

Photographer: Nick Kane

The Abercrombie Building, Headington Campus, is part of Oxford Brookes University and situated in a residential area about one mile east of Oxford city centre. As with many of the UK's younger Universities, the roots of Oxford Brookes are long established, starting life in 1865. Now, it is a multi-site, multi-faculty University. With the team DAL developed BORDO, a linear lighting and services system. This, together with surface mounted and recessed downlighters, including Ambiance X100 LED downlighters, forms a cohesive lighting strategy for New Teaching and Library Building. The new extension is linked to the existing building by glass bridges and shared meeting galleries, forming a dramatic interior with internal spaces opening onto 'The Void', which allows natural ventilation and lots of daylight.

Education

City University, London
Cranleigh School Abu Dhabi
Oxford Brookes University, The
Abercrombie Building, Headington
Campus
ACS Internal School, Cobham
Thomas Tallis School, Kidbrook, London
DMS Watson Building, University
College London
University of Westminster, Wells Street
Campus, London.

Senate House, University of London
The Cloisters, University College
London
University College London Library
King Solomon Academy, London
Queen Mary University, London
Imperial College London
Anatomy Building, University College
London
Chelsea College of Art and Design,
University of the Arts London

Wolfson Dining Hall, St Edmund Hall,
Oxford
The Chapel, Uppingham School,
Leicestershire
College of Law, Birmingham
Haberdasher Askes Schools
Kingston Grammar School, Surrey
Emmanuel College, Cambridge
University of East Anglia, Sainsbury
Centre for the Visual Arts
Sultan Qaboos University, Oman

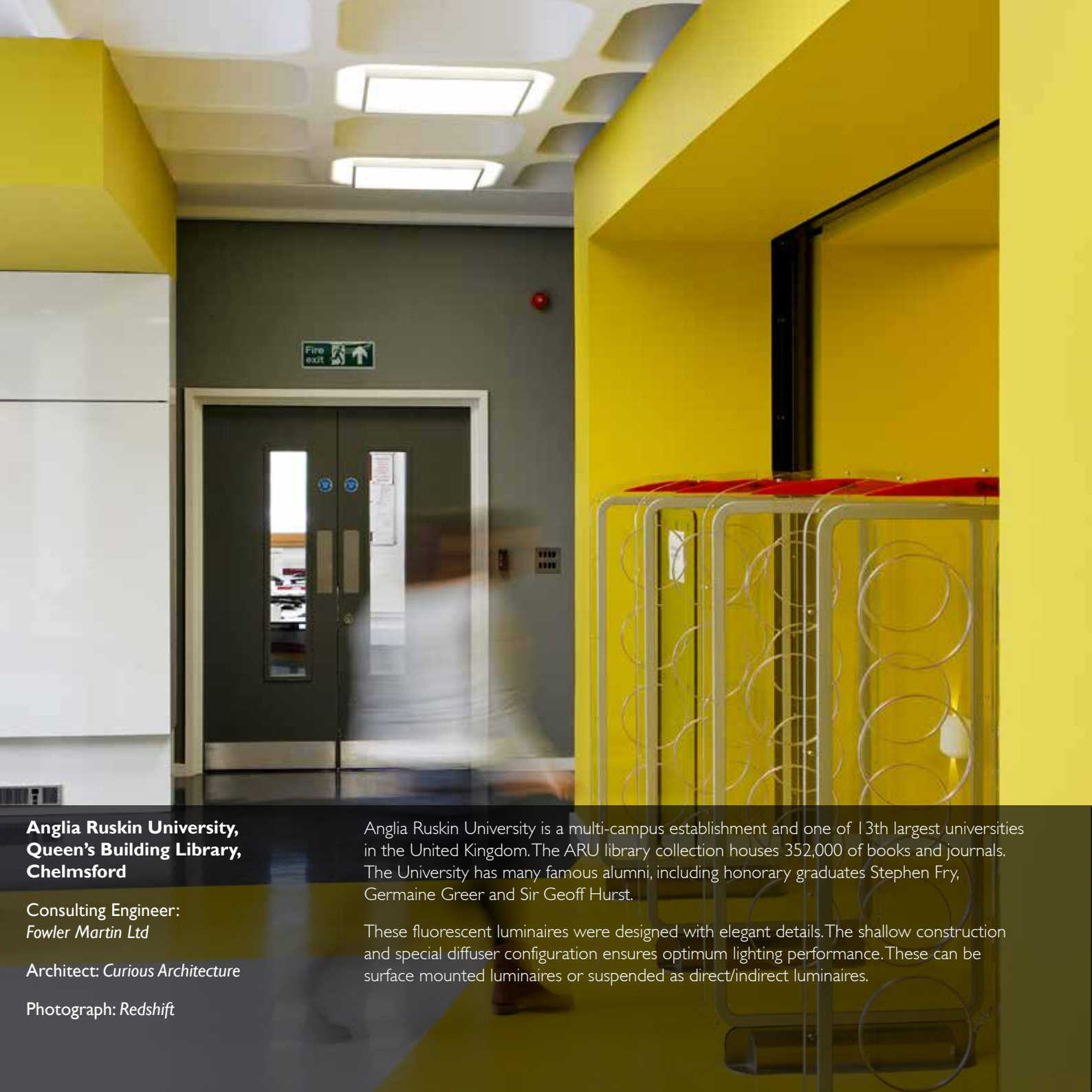

**Anglia Ruskin University,
Queen's Building Library,
Chelmsford**

Consulting Engineer:
Fowler Martin Ltd

Architect: *Curious Architecture*

Photograph: *Redshift*

Anglia Ruskin University is a multi-campus establishment and one of 13th largest universities in the United Kingdom. The ARU library collection houses 352,000 of books and journals. The University has many famous alumni, including honorary graduates Stephen Fry, Germaine Greer and Sir Geoff Hurst.

These fluorescent luminaires were designed with elegant details. The shallow construction and special diffuser configuration ensures optimum lighting performance. These can be surface mounted luminaires or suspended as direct/indirect luminaires.



Wolfson Dining Hall

Lighting Design:
dpa lighting consultants

Architect:
GBS Architects Oxford

Photographer
dpa lighting consultants

Wolfson Dining Hall is part of St Edmund Hall, one of the oldest colleges of the University of Oxford, which is named after St Edmund of Abingdon, Archbishop of Canterbury (1234-40). Situated in the centre of the City of Oxford and close to the River Isis and the Church Meadows Wolfson is famous for its conference facilities and 'high table' cuisine.

DPA's concept required a unique system with custom designed luminaires integrated with the bespoke ironwork and specially constructed ceiling.

The college has many notable alumni including Sir Robin Day, the broadcaster.



University College London

Lighting Consultant:
Maurice Brill Lighting Design

Consulting Engineer:
Fowler Martin Ltd

University College London was founded in 1826 to provide a progressive alternative education to that offered at Oxford and Cambridge Universities. Originally designed by William Wilkins (the architect of London's National Gallery) the airy North and South Cloisters have been refurbished recently. The work included an upgrade to the lighting.

The fittings, still in keeping with the existing opal glass pendants, house both metal halide and compact fluorescent lamps increasing the lighting levels with a more technical lighting solution.



**Senate House Library,
University of London**

Architect:
Charles Holden/BDP

Lighting Consultant:
BDP Lighting

Senate House is the administrative centre of the University of London, situated in the heart of Bloomsbury. When the Art Deco building was completed in 1937 its 19 story, 64m tower made it the second tallest building in London. St Paul's Cathedral being the first. Combined uplighting and downlighting was a favoured lighting technique of the era and when the recent refurbishment of the building required new luminaires this method was used.

The aesthetic of the luminaire (over 800 were manufactured and supplied) took on the feel of the building. The resulting design included a step detail and 'old penny bronze' finish that mimicked the existing building's features. The microprism diffuser gives a low brightness appearance to the high lumen package circular fluorescent lamp incorporated in the luminaire.

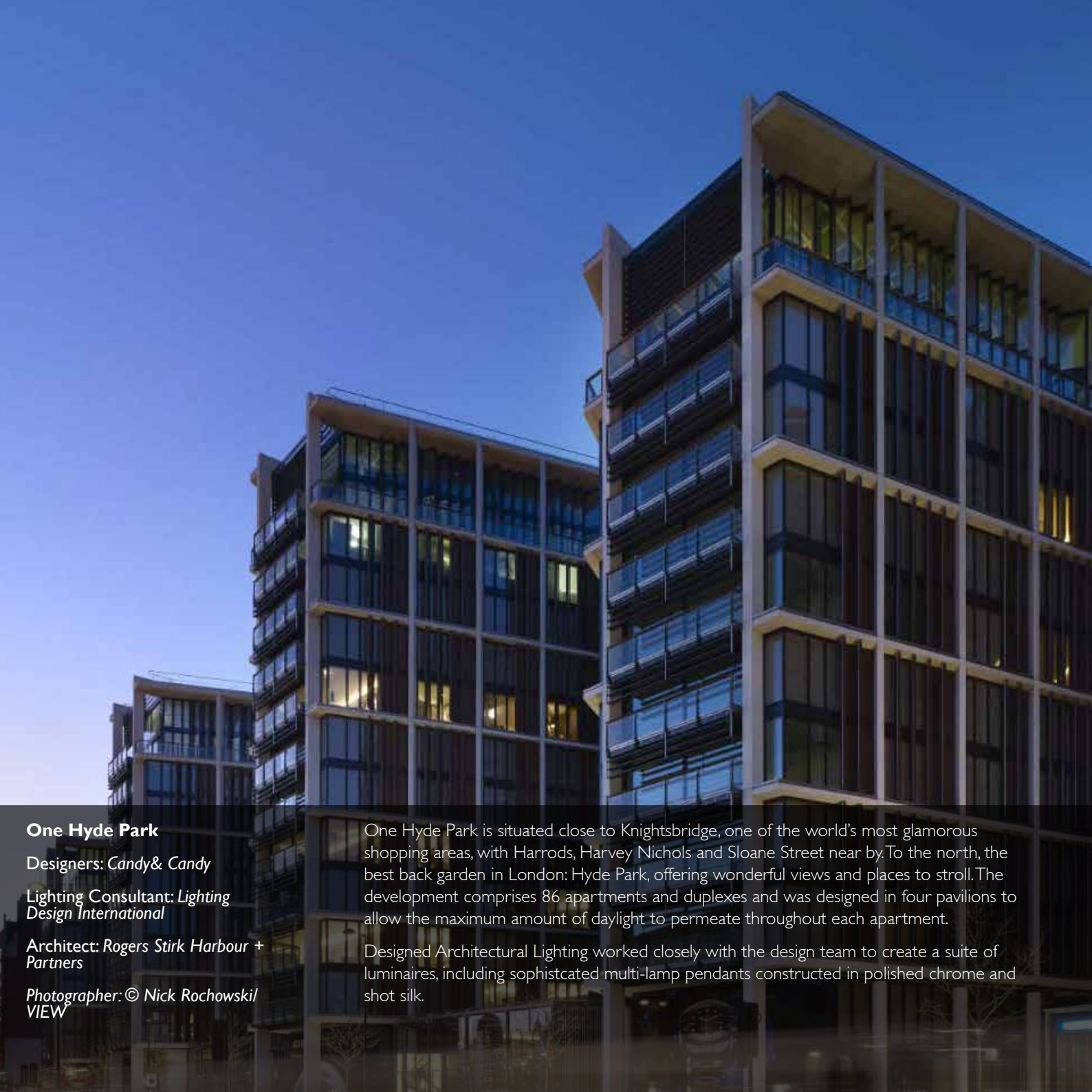

One Hyde Park

Designers: *Candy & Candy*

Lighting Consultant: *Lighting Design International*

Architect: *Rogers Stirk Harbour + Partners*

Photographer: © *Nick Rochowski VIEW*

One Hyde Park is situated close to Knightsbridge, one of the world's most glamorous shopping areas, with Harrods, Harvey Nichols and Sloane Street near by. To the north, the best back garden in London: Hyde Park, offering wonderful views and places to stroll. The development comprises 86 apartments and duplexes and was designed in four pavilions to allow the maximum amount of daylight to permeate throughout each apartment.

Designed Architectural Lighting worked closely with the design team to create a suite of luminaires, including sophisticated multi-lamp pendants constructed in polished chrome and shot silk.

Residential

St Georges Tower - Vauxhall
One Hyde Park, London
Victoria Hall, Student Complex, Wembley
St George, Mary Datchelor House,
London
Berkeley Homes, Richmond Upon

Thames
St George, Dickens Yard, Ealing, London
Private Residence, Gstaad, Switzerland
Pan Peninsula, Docklands, London
Battersea Reach, London
NIDO Pentonville, London

NIDO Spitalfields, London
Latitude, Monk Bridge, Leeds
Kailash Residence, Chennai, India

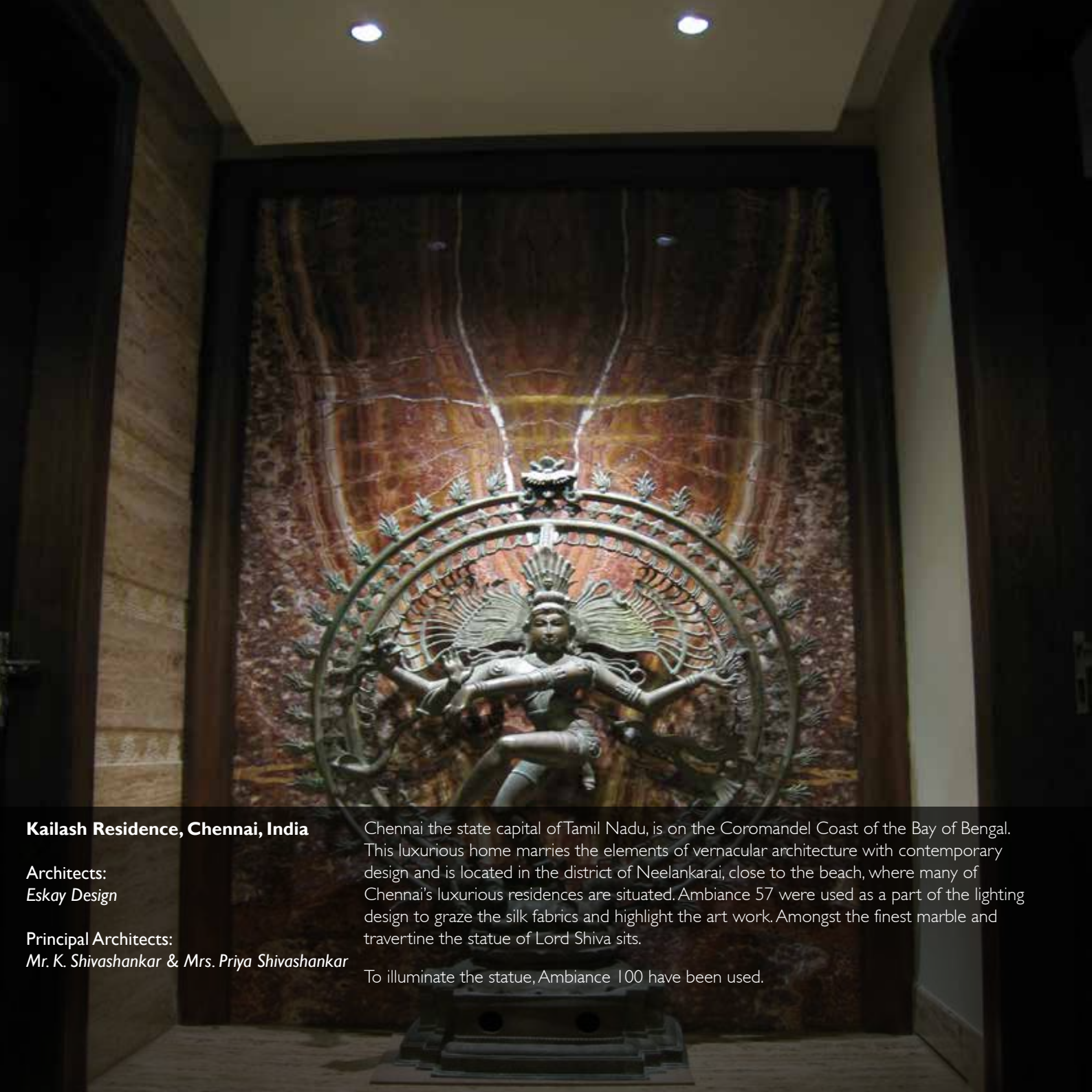

Kailash Residence, Chennai, India

Architects:
Eskay Design

Principal Architects:
Mr. K. Shivashankar & Mrs. Priya Shivashankar

Chennai the state capital of Tamil Nadu, is on the Coromandel Coast of the Bay of Bengal. This luxurious home marries the elements of vernacular architecture with contemporary design and is located in the district of Neelankarai, close to the beach, where many of Chennai's luxurious residences are situated. Ambiance 57 were used as a part of the lighting design to graze the silk fabrics and highlight the art work. Amongst the finest marble and travertine the statue of Lord Shiva sits.

To illuminate the statue, Ambiance 100 have been used.



One Hyde Park

Designers: *Candy& Candy*

Lighting Consultant: *Lighting Design International*

Architect:
Rogers Stirk Harbour + Partners

One Hyde Park is a modern landmark residential development in prestigious Knightsbridge, London. DAL worked closely with the design team to design a selection of custom luminaires that complemented the lavish interior decoration. A selection of wall and pendant fixtures were manufactured in highly polished chrome and shot silk.



Battersea Reach, London

Lighting Consultant:
Light Bureau

Architect:
Broadway Malyan Architects

Client:
St George South London Ltd

Photography:
Amber Room

Battersea Reach Tower is situated on the south side of the Thames, adjacent to Wandsworth Bridge, and is in close proximity to London's most fashionable areas of Chelsea and Fulham. The stunning and innovative, eco friendly seventeen story development is a striking new addition to the London skyline.

Quad Single and Quad Double downlighters were used extensively throughout this project and other St George developments.

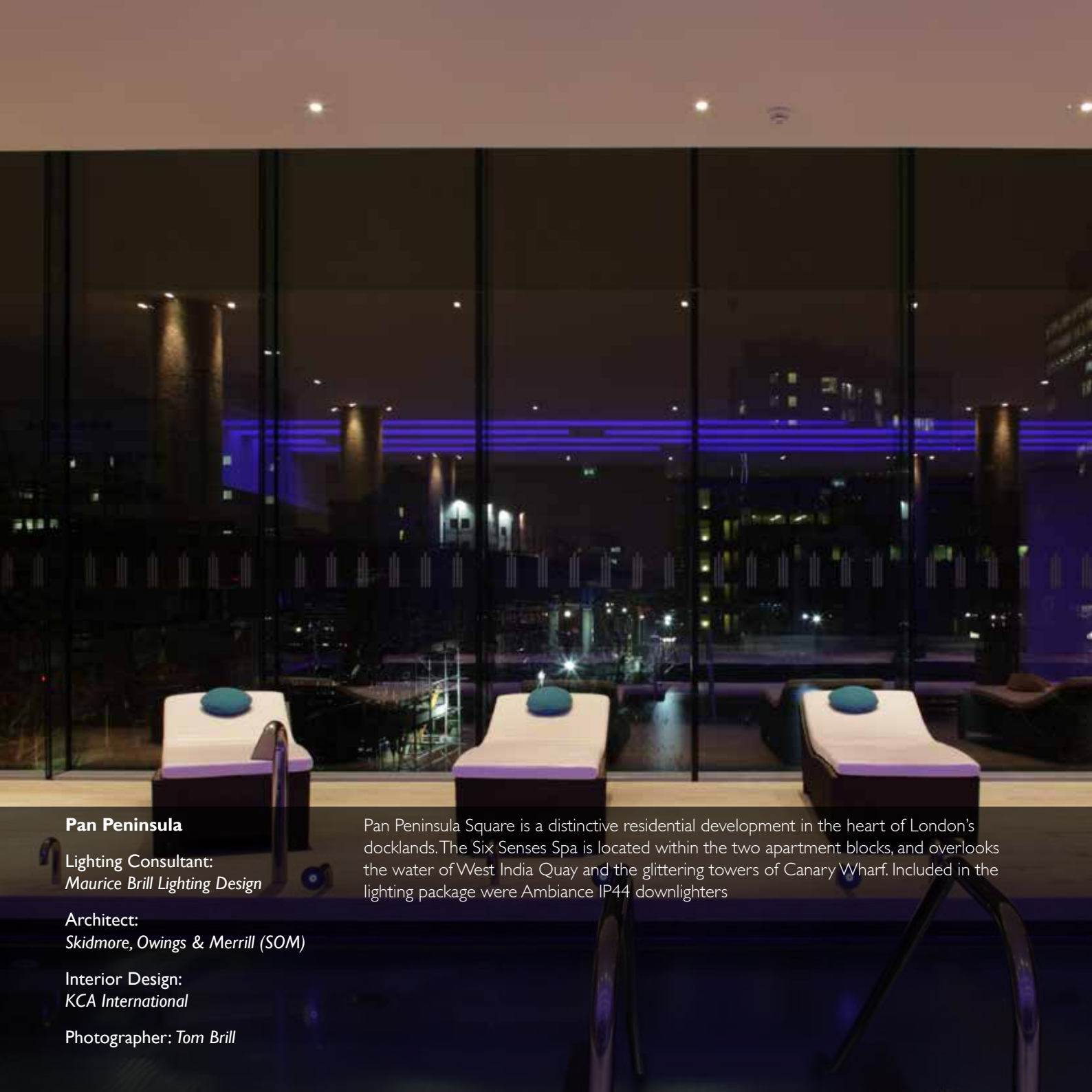

Pan Peninsula

Lighting Consultant:
Maurice Brill Lighting Design

Architect:
Skidmore, Owings & Merrill (SOM)

Interior Design:
KCA International

Photographer: *Tom Brill*

Pan Peninsula Square is a distinctive residential development in the heart of London's docklands. The Six Senses Spa is located within the two apartment blocks, and overlooks the water of West India Quay and the glittering towers of Canary Wharf. Included in the lighting package were Ambiance IP44 downlighters



**Virgin Atlantic Clubhouse,
Hong Kong**

Lighting Design:
CLA Hong Kong

Interior Designs:
HL-STUDIOS

The Clubhouse bar is the most popular place to be with its warm, upmarket interior. The sparkling design is set off with Ambiance downlighters and is the perfect place for a beer or cocktail prior to boarding your Virgin Atlantic flight.

Transportation

Virgin Atlantic Lounge, Hong Kong
DLR Custom House (ExCel), London
Docklands
DLR Prince Regent (ExCel), London
Docklands
Crossrail Projects, London and South East
England
Euston Station Concourse, London

Fayair, Stansted Airport
Liverpool Street Station, London
Stratford Station, London
Charing Cross Station, London
KCRC, Shatin, Hong Kong
Hong Kong Station Redevelopment
Ground Transportation Centre, Hong-
Kong

Gatwick Airport North and
South Terminals
Heathrow Terminal 1
Stansted Airport
London City Airport, Docklands
Liverpool John Lennon Airport
Dublin Airport, Pier D
Chek Lap Kok Airport, Hong Kong



**Private Airline Lounges,
Stansted Airport**

Lighting Consultant:
Paul Nulty, PNL

Photographer:
© Sanna Fisher-Payne

There is more to London's Stansted Airport than one would expect, it's not just for budget airlines it is also a gateway for the individual traveller. As befits an exclusive airline facility the interior finishes and design detail of the reception area and passenger lounges are of the highest quality. The architectural aesthetic is strengthened by the use of a bespoke concealed cover lighting and DAL's TERRA LED 150 recessed floor system, which enhances the rich dark wood and emphasises the clean lines and long expanses of warm marble; materials that are complimented by the LED's specially chosen for the project.



Dublin Airport, Pier D

Lighting Consultant:
Lighting Design International

Architect:
*Skidmore, Owings & Merrill
(SOM)*

Photographer:
Gerry O'Leary

Dublin Airport (Aerfort Bhaile Átha Cliath) is located approximately 10km north of Dublin City in a once rural area near Swords, in the Fingal part of County Dublin. The airport is the headquarters of Ireland's flag carrier Aer Lingus, and Europe's largest no-frills airline Ryanair. One of the most fascinating features within the building are the murals located at each boarding gate.

Known as the Irish Writers' Gallery, twelve writers are celebrated and include three Nobel Prize winners. W.B. Yeats, George Bernard Shaw and Samuel Beckett, as well as the literary giants Oscar Wilde, Sean O'Casey and James Joyce are represented. Texts from the work of each author are used in the murals, reflecting the themes of travel, nationality and hospitality, paying tribute to urban and rural Ireland.



**Hong Kong International
Airport (Chek Lap Kok)**

Architect: *Foster+Partners*

Lighting Consultant: *Fisher Marantz
Stone (FMS)*

Consulting Engineer: *Ove Arup*

Photographer: *Dennis Gilbert*

DAL worked closely with Fisher Marantz Stone in the development of 26 different custom luminaire types for Hong Kong International Airport which is still a most prestigious project and one of the largest engineering and architectural developments in the world. In 1998 the Airport was inaugurated by the President of the People's Republic of China, Jiang Zemin, and reports say that Bill Clinton, the US President at the time, was the first international passenger to have used the airport, on the last leg of his tour of China.



DLR, Canarywharf

Client:
Canary Wharf Group PLC

Design Installation: *TClarke PLC*

In the late 1980s, to stimulate the regeneration of the area, the London Docklands Development Corporation needed to provide additional public transport. Initially there were eight miles of track and fifteen stations, of which Canary Wharf was one. Now there are seven lines and 45 stations. Interestingly, the first phase utilised some of the existing dock railway infrastructure to link the West India Docks to Tower Hill.

Canary Wharf station is one of the bigger stations, nestling within the base of One Canada Square. Custom House, Prince Regent and Canary Wharf stations were the first to be upgraded in an ongoing programme of works.



Docklands Light Railway, Canary Wharf Station

Client: Canary Wharf Group PLC

Design Installation: TClarke PLC

As part of the ongoing up-grade and refurbishment programme of several DLR stations the brief for Canary Wharf included particular lighting requirements: increased light level, improved uniformity and luminaire adjustment. As a result DAL designed and supplied new and additional light fixtures. Customised TEMPO X161 with 60 degree beam spread and DAL BORDO 150 linear system were specified. The surface-mounted BORDO system houses gimbal style downlighters, as well as cabling and other building services.



The London Eye

*Architect and Designer:
Marks Barfield Architects*

Photographer: Peter Messett

The London Eye is a giant amid London's cityscape, and from it over twenty million visitors have enjoyed unparalleled views over the capital. Although now ablaze with colour-changing drama the original lighting concept for 'The Eye' required only white light. At night just the rim was to be illuminated with a continuous ring of light: no light on the spokes, and the passenger capsules were to glow from inside. To enable this vision the Rim Lights were developed, using fluorescent light sources and precisely designed reflectors enclosed in extruded polycarbonate tubes that were sealed in a complex construction of aluminium castings and plates, which facilitated the luminaires to be aimed and adjusted. Baffles and louvres were necessary to limit direct views of the lamps from the travellers.

Aviva Stadium,

Architect:
Populous/Scott Tallon Walker

Consultants:
ME Engineers

DAL supplied over 12,000 luminaires for the Aviva Stadium, Ireland's spectacular landmark and international sports and rock venue. Formerly known as Lansdowne Road (Bóthar Lansdún) it is situated in Ballsbridge, the leafy South Dublin suburb. The original stadium, built in the late 1800s, was home to the Irish International Rugby Union team and joined there in the 1990s by the International football team.

The lighting package comprised twenty different luminaire types, including downlighters and wall-washers for the hospitality suites and public spaces. High quality recessed and surface mounted IP rated fixtures are installed in the circulation and escape areas, and custom designed LED luminaires integrated within the stadium's handrails. 700 STORM drum downlighters were mounted on the columns surrounding the perimeter of the grandstand, creating both feature and ambient lighting.

London Studio, 48 Britton Street
London EC1M 5UL

T +44 (020) 7490 3998

